

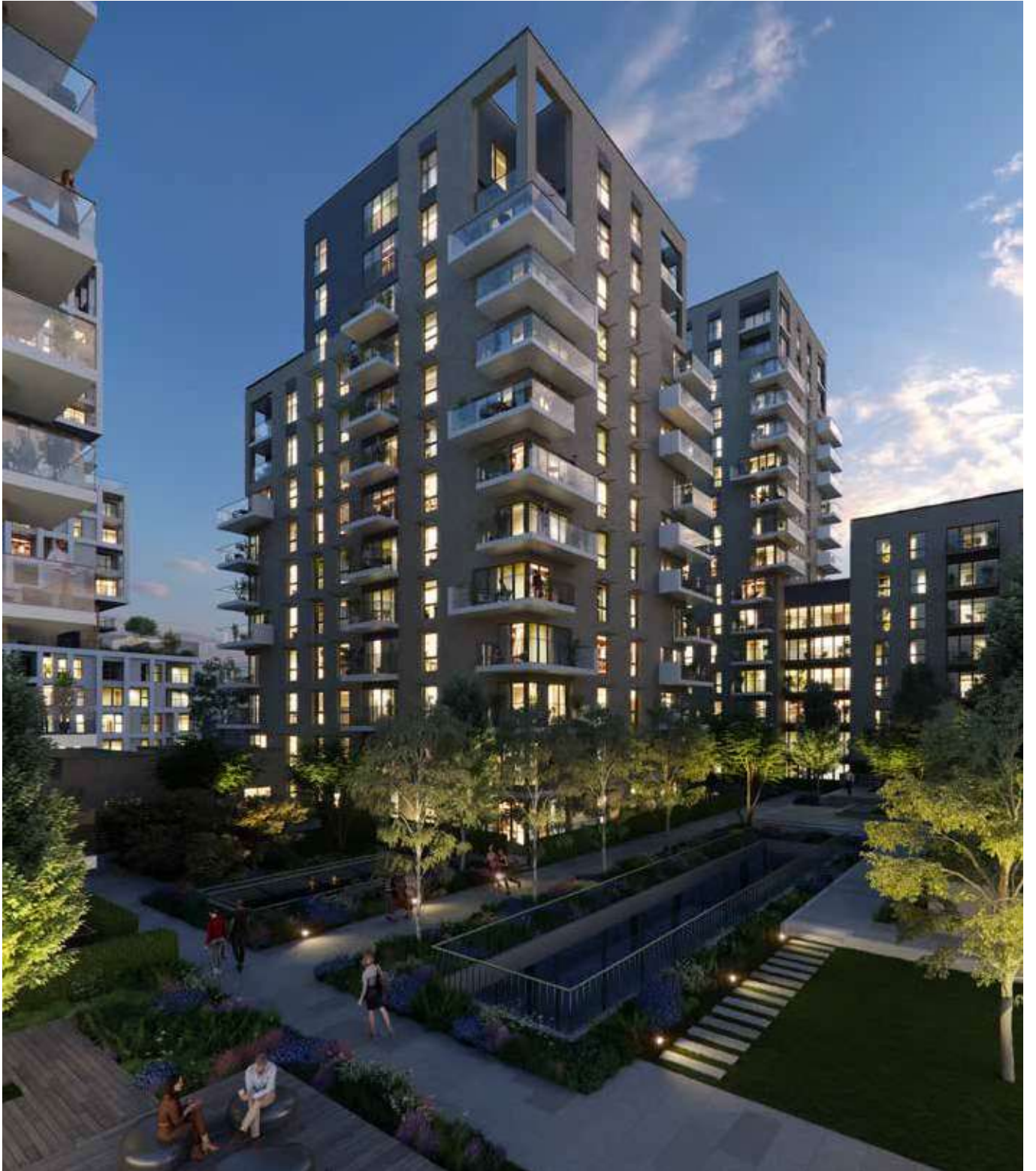

TURYAP[®]
UK





CENTRUM COURT

DESIGNED TO BE DIFFERENT,
CENTRUM COURT SETS A NEW STANDARD
FOR CONTEMPORARY LIVING.

At the heart of The Village Centre and bordering the stunning Cator Park, Centrum Court comprises a selection of 1, 2 and 3 bedroom apartments, penthouses and townhouses. With great local amenities, beautiful surroundings and quick links to the Capital, Centrum Court is a place to connect.

INTRODUCING CENTRUM COURT

GET CONNECTED TO THE PEOPLE,
COMMUNITY AND CITY OF THIS SPECIAL
CORNER OF THE CAPITAL.

Set in the heart of The Village Centre, Centrum Court offers spacious, modern living that blends the best of village and city life. Here you are connected to all you need to enjoy an enviable London lifestyle.

Drop in to the local shops, right on your doorstep, for all your everyday essentials. Relax over coffee and take in the landscaped piazza and podium, with picturesque Cator Park directly opposite your home. You're also only a stone's throw from Kidbrooke Station taking you into central London in just 16 minutes*, making it the perfect place to commute, commune and connect.



CGI of The Village Centre at Kidbrooke Village, indicative only.
*Timing is approximate only and does not include walking distances. Source: tfl.co.uk



CONNECTED LIVING

CENTRUM COURT IS PERFECTLY PLACED TO ACCESS THE VERY BEST OF WHAT THE CAPITAL HAS TO OFFER.

The beating pulse of central London is only a short trip from Centrum Court, making it ideal for commuting, nights out and day trips with family and friends. As the undisputed heart of the country's commerce, culture and entertainment, this fast-paced city never fails to surprise and delight.

Here you can take advantage of world-class cuisine, exceptional shopping, ground-breaking arts, award-winning theatre and breathtaking historical monuments. London has something for everyone.

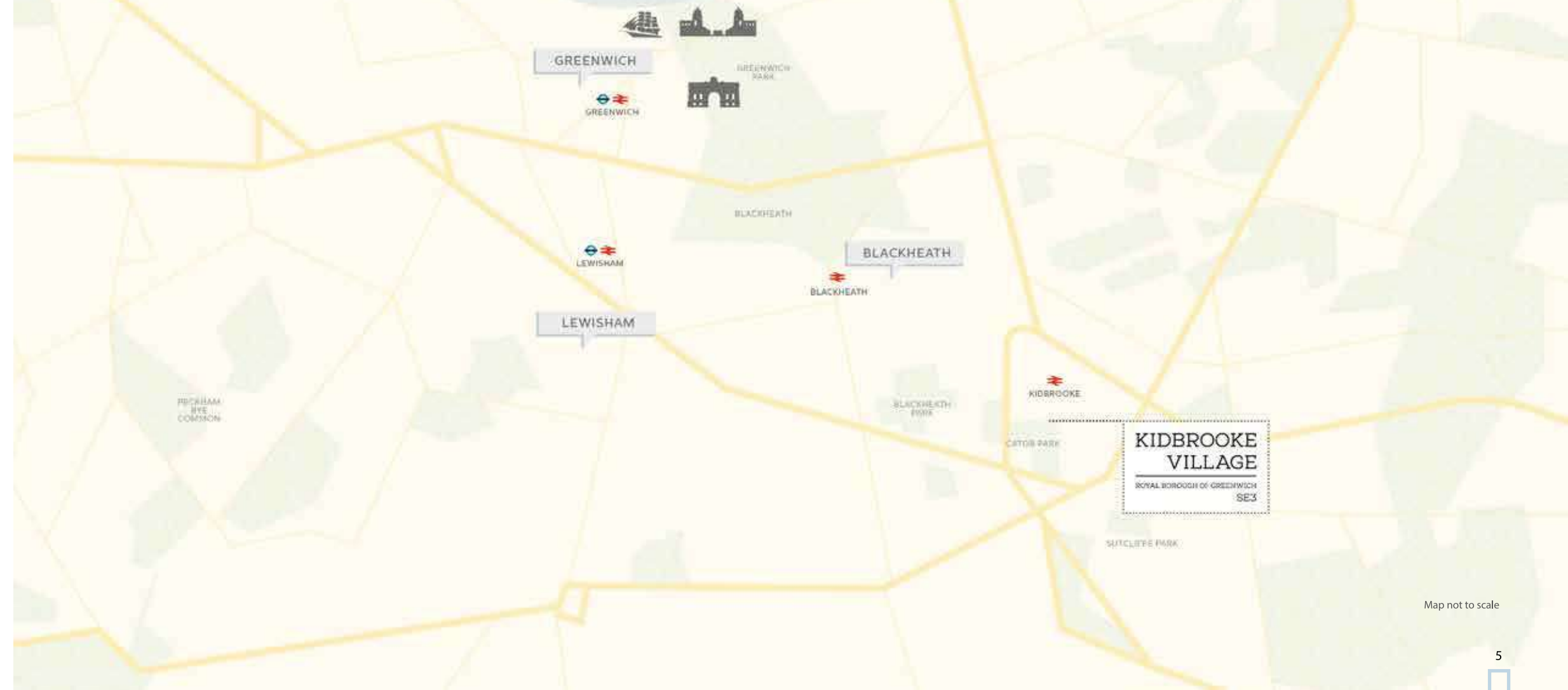



A GATEWAY TO CENTRAL LONDON

THE CAPITAL IS ONLY MINUTES AWAY FROM CENTRUM COURT.

Regular trains from Kidbrooke station can take you to London Bridge, Waterloo East, Charing Cross and Victoria stations, where you can join the London Underground network. Trains also connect to Lewisham, providing DLR to Greenwich, Canary Wharf, Stratford and London City Airport.

There's also a regular bus service into London, while safe pedestrian and cycle routes from Kidbrooke Village give you the opportunity to get to town at your leisure.

22
MINUTES TO
CANARY WHARF *

16
MINUTES TO
LONDON BRIDGE *

JOURNEY TIMES FROM KIDBROOKE



*Journey times are approximate only and do not include walking distances. Source: www.tfl.gov.uk.

THE LONDON LIFESTYLE

AT CENTRUM COURT, YOU'RE JUST 16 MINUTES FROM LONDON BRIDGE, A DISTRICT OVERFLOWING WITH CULTURE AND HISTORY.

Borough Market offers some of the finest produce in the UK, with an eclectic selection of restaurants and bars, dotted along its winding cobbled streets. The dizzying heights of Aqua Shard towers over the skyline, below which you can find a multitude of museums, theatres and shops in this lively and exciting pocket of London.



Tower Bridge



Aqua Shard



Lifestyle photography, indicative only

MINUTES FROM CANARY WHARF

ONCE ONE OF THE BUSIEST PORTS IN THE WORLD, CANARY WHARF IS NOW THE CAPITAL'S SECOND FINANCIAL DISTRICT, AS WELL AS BEING A FLOURISHING LEISURE DESTINATION.

22 minutes from Kidbrooke Village, Canary Wharf features striking architecture, including the iconic pyramid-topped One Canada Square and the Foster + Partners designed Underground station.

The 97 acre development has a vibrant and cosmopolitan feel, with some 300 restaurants, bars and shops and a packed arts and entertainment programme.



Canary Wharf



Lifestyle photography, indicative only



Lifestyle photography, indicative only



Emirates cable car

LET THE O2 ENTERTAIN YOU

THE O2 IS ONE OF BRITAIN'S MOST EXCITING ENTERTAINMENT VENUES AND IT'S CONVENIENTLY CLOSE TO KIDBROOKE VILLAGE.

The world's biggest names in entertainment choose the O2 for their landmark gigs. It can accommodate audiences of 20,000 and the building is undoubtedly spectacular. However, the O2 is more than simply a giant dome; it's a complete entertainment and leisure complex, with restaurants, bars, Brooklyn Bowl, a Cineworld cinema, exhibition space and much more.

When you want a great night out, the O2 can be reached by car from Kidbrooke Village in well under 10 minutes*, or for a more exciting way to arrive, take the Emirates Air Line cable car from Royal Victoria Docks.

*Timing is approximate only



BUSTLING BLACKHEATH AND BEYOND

THE ROYAL BOROUGH OF GREENWICH IS A PLAYGROUND FOR SOCIALISING, RELAXING AND DINING OUT.

There's a plethora of bakeries, brasseries and bars just round the corner from Centrum Court, perfect for letting your hair down and enjoying some time with friends. Blackheath, just 3 minutes* away by train, with its array of independent shops, cafés and pubs is set up for socialising in style,



Lifestyle photography, indicative only

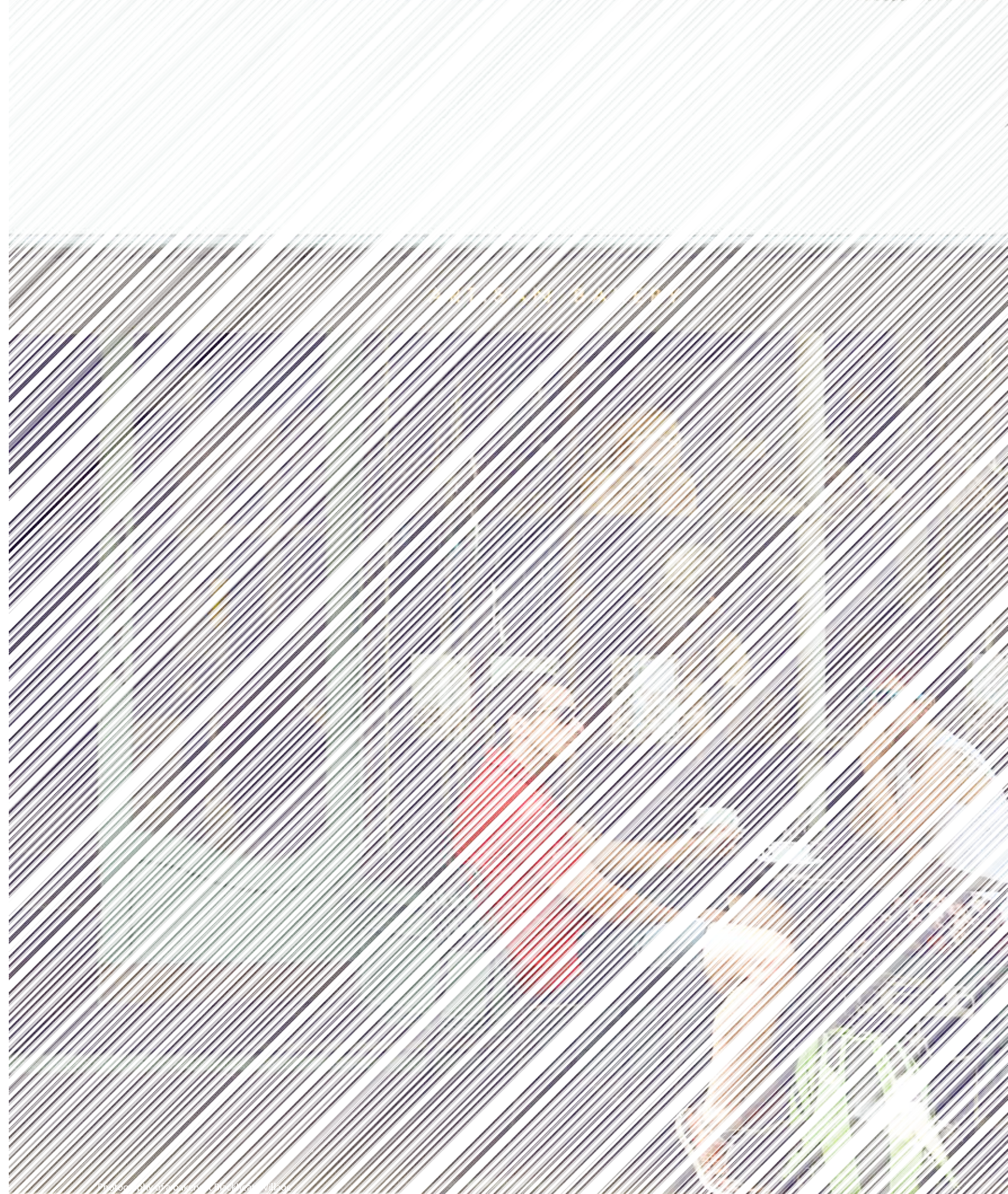
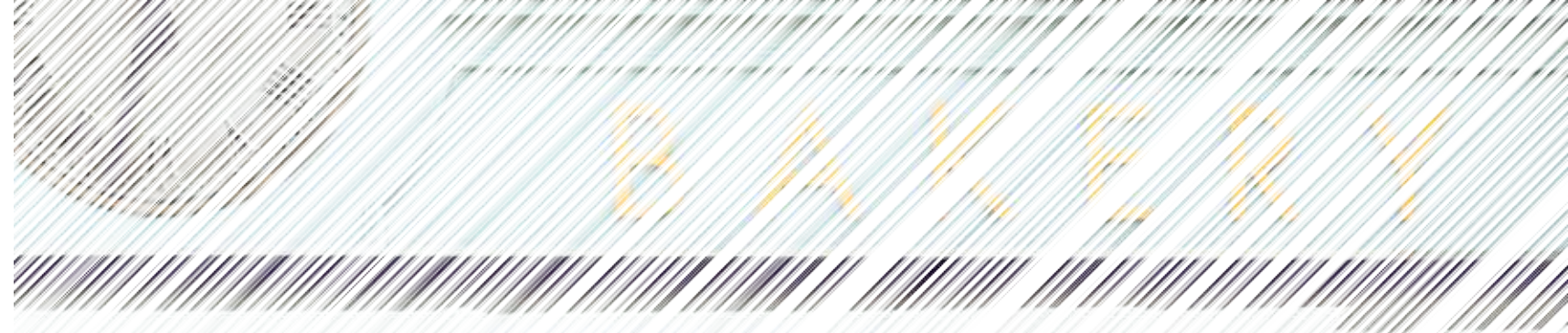

*Timing is approximate only. Source: tf.co.uk

INTRODUCING KIDBROOKE VILLAGE

KIDBROOKE VILLAGE COMPRISES OF FOUR DISTINCT NEIGHBOURHOODS; THE VILLAGE CENTRE, MERIDIAN GATE, BLACKHEATH QUARTER AND CITY POINT.

Centrum Court is located at the heart of The Village Centre, where the newly built Kidbrooke Station is on your doorstep along with a wealth of amenities which includes, a Sainsbury's supermarket, shops, cafés, a Young's pub and dining and a health centre.

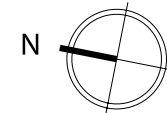
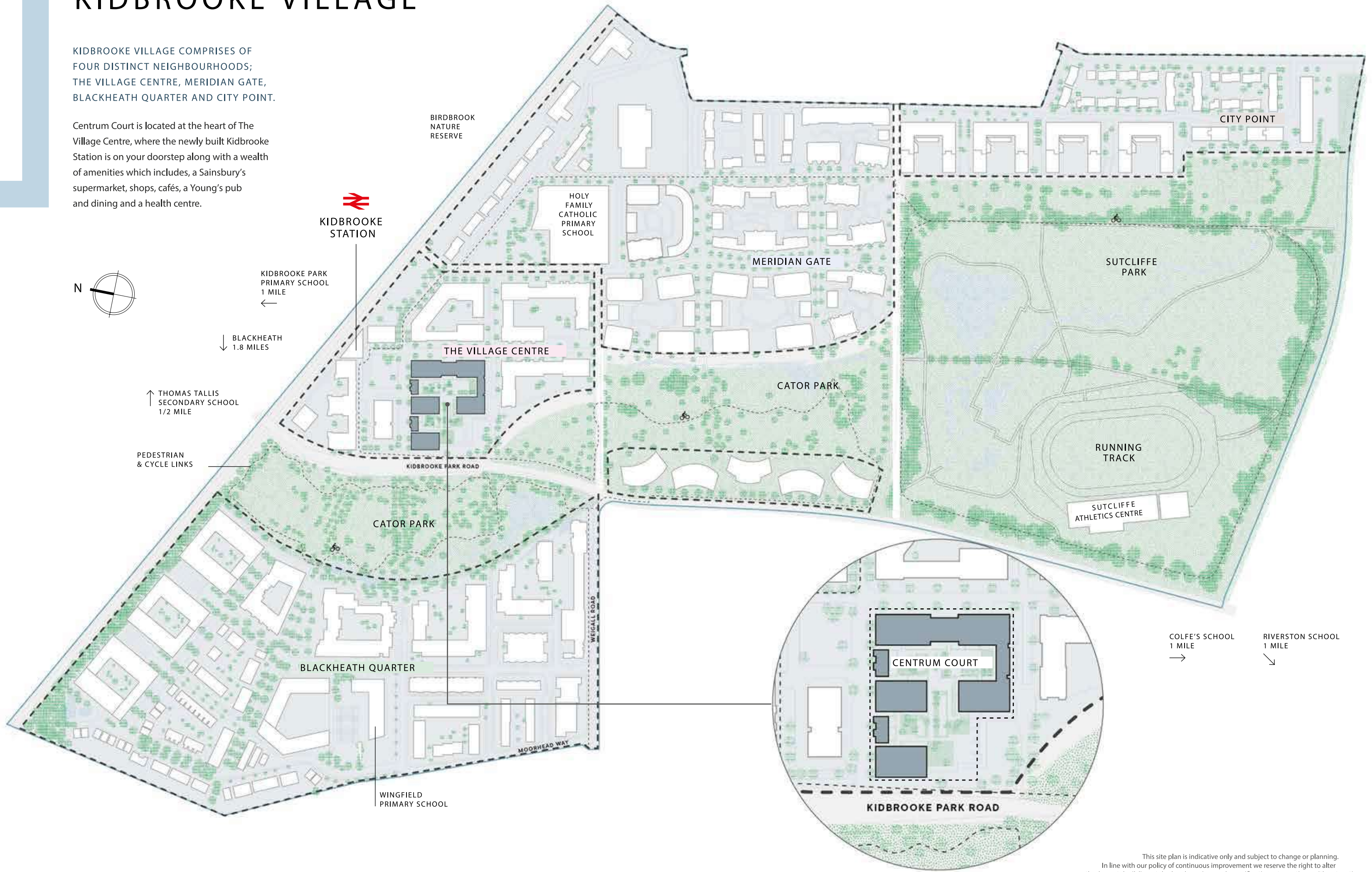

KIDBROOKE PARK PRIMARY SCHOOL
1 MILE ←

BLACKHEATH
1.8 MILES ↓

↑ THOMAS TALLIS SECONDARY SCHOOL
1/2 MILE

PEDESTRIAN & CYCLE LINKS

COLFE'S SCHOOL
1 MILE →

RIVERSTON SCHOOL
1 MILE ↘

This site plan is indicative only and subject to change or planning. In line with our policy of continuous improvement we reserve the right to alter the layout, building style, landscaping and specification at any time without notice. Distances given are driving distances and approximate only. Source: www.google.co.uk/maps



CONVENIENCE ON YOUR DOORSTEP

There are plenty of local amenities to satisfy your daily needs, such as a Sainsbury's supermarket, coffee shop, dentist, doctor and pharmacy, not to mention Kidbrooke train station. There will also be shops, restaurants, leisure facilities and an impressive central piazza over the coming year, including a Young's pub and dining.



CONNECTED TO PEOPLE

THE SENSE OF COMMUNITY IS A VITAL
ELEMENT OF LIFE AT CENTRUM COURT

The moment you step outside your door, you will instantly feel part of the bustling and friendly local community of Kidbrooke Village. This well-established community spirit has been carefully fostered, creating spaces and facilities for meeting, socialising and sustaining village life. Get together for a coffee, do the daily shop or take a stroll in one of the parks.



Lifestyle photography, indicative only



Lifestyle photography, indicative only

THE HEART OF VILLAGE LIFE

CENTRUM COURT SITS IN THE VILLAGE CENTRE - THE CENTRAL HUB OF VIBRANT KIDBROOKE VILLAGE.

Centrum Court is at the focal point of village life.

Carefully landscaped walkways and fountains are the backdrop to a bustling local hub.

The considered design of Centrum Court extends your home into the local environment, so that you always feel part of village life.

The architecture works in balance with the neighbouring Cator Park, creating a tranquil and dynamic environment.



SOCIAL CONNECTIONS

KIDBROOKE VILLAGE IS A GREAT
PLACE TO GATHER WITH FRIENDS.

Spend lazy weekends relaxing at The Village
Centre - picking up the day's essentials,
lounging in the local coffee shop or just taking
in the atmosphere. You can also get together
for a night out or much needed catch up at
The Village Centre's pub.

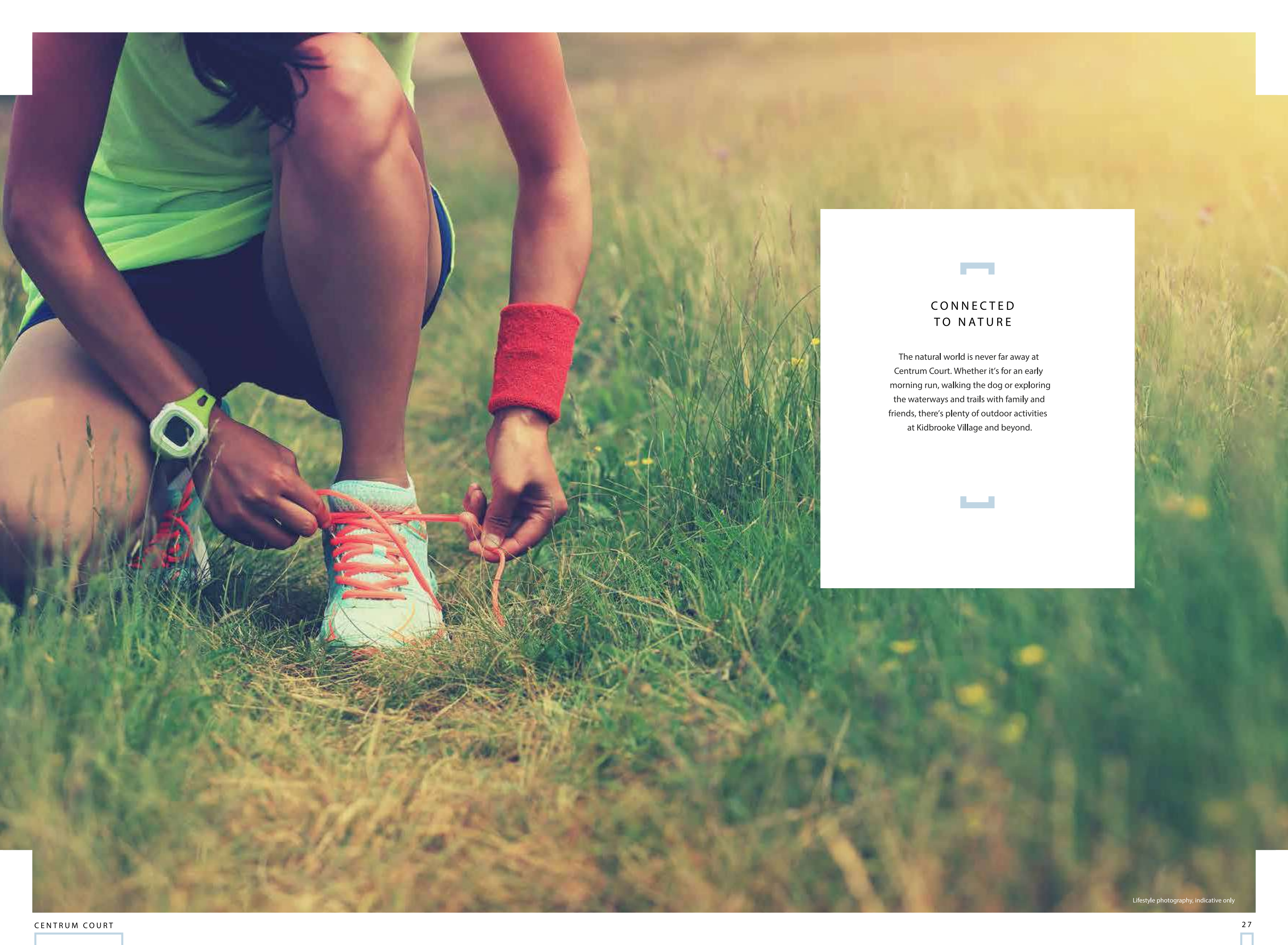

CONNECTED
TO NATURE

The natural world is never far away at Centrum Court. Whether it's for an early morning run, walking the dog or exploring the waterways and trails with family and friends, there's plenty of outdoor activities at Kidbrooke Village and beyond.

A BREATH OF FRESH AIR



Photography at Sutcliffe Park



WITH 35 ACRES OF OPEN PARKLAND
TO EXPLORE AT KIDBROOKE VILLAGE,
IT'S EASY TO ESCAPE INTO THE
GREAT OUTDOORS.

You can explore the wide open spaces of the established Sutcliffe Park and the newly created Cator Park, meaning you are always close to nature.

Cator Park benefits from stunning landscaping and water features, forming a green river through the village, connecting all the neighbourhoods. This leads into Sutcliffe Park, which has Green Flag status and a celebrated nature reserve.

Berkeley is ensuring nature will continue to flourish here by working with London Wildlife Trust.

Photography of Cator Park

STUNNING LANDSCAPING

FEEL A SENSE OF TRANQUILLITY
IN THE BEAUTIFULLY LANDSCAPED
SURROUNDINGS OF CENTRUM COURT.

One of the outstanding features is the stunning landscaping of the built and natural environments around Centrum Court, most notably your private residents' podium. Here you can enjoy your very own carefully designed space where you can relax, get together with friends and enjoy being outside throughout the year.





THE BUILDING

DESIGNED TO BE DIFFERENT,
CENTRUM COURT SETS A NEW STANDARD
FOR CONTEMPORARY LIVING.

CGI of Kidbrooke Village, indicative only

CENTRUM COURT



Lifestyle photography, indicative only



Lifestyle photography, indicative only



Lifestyle photography, indicative only

- RESIDENTS' ONLY GYM
- 24-HOUR CONCIERGE
- CAR SHARE CLUB
- CYCLE STORE

FIRST CLASS AMENITIES

A SENSE OF WELLBEING IS ALL PART OF THE LIFESTYLE ON OFFER AT CENTRUM COURT.

The residents' only gym in The Village Centre makes it easy to stay fit, healthy and active while a 24-hour Concierge offers an essential service for busy Londoners - from accepting home deliveries to greeting visitors. There's even a Kidbrooke Village car club, providing an economical car hire service, dispensing with the need to own your own car. And bike lovers haven't been forgotten either, there's a bike store in the basement and cycle paths throughout the development and to Central London, perfect for all.

INSPIRED INTERIORS

THOUGHTFULLY DESIGNED, CONTEMPORARY OPEN-PLAN SPACES, WITH PRIVATE BALCONIES, ARE PERFECT FOR ENTERTAINING OR RELAXING WITH FAMILY AND FRIENDS.

Well planned, light filled living spaces open up before you, where details include Amtico flooring which seamlessly flows throughout the living area, hallway and kitchen.

Options and choices are available (subject to cut off dates). Please see Sales Consultant for details. Berkeley reserves the right to make any changes to the options and choices without notice.

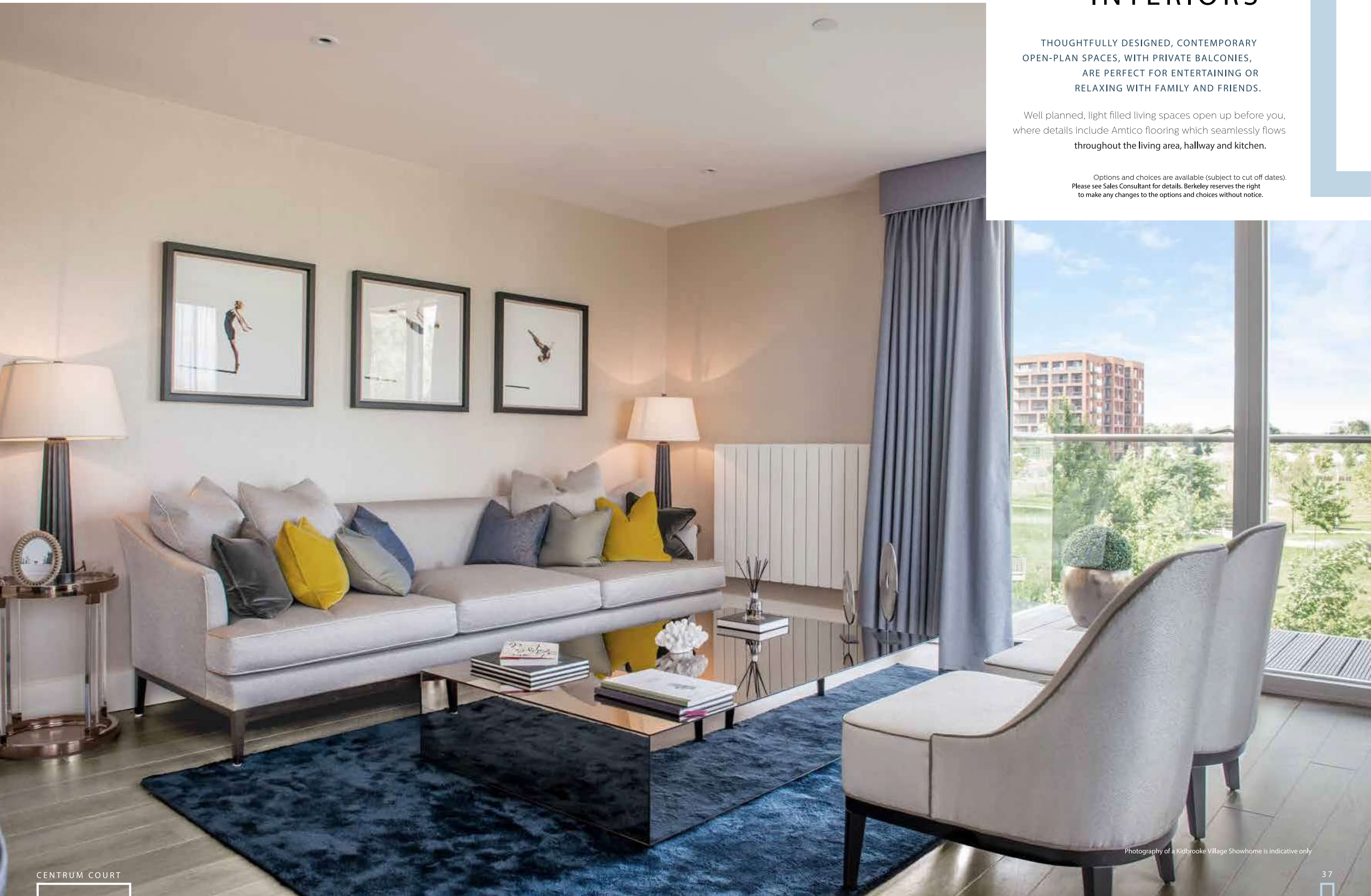

WELL APPOINTED KITCHENS

YOUR KITCHEN IS INDIVIDUALLY PLANNED
AND DESIGNED TO SUIT THE LAYOUT OF
YOUR HOME.

Smart contemporary details include composite stone
worktops, glass splashbacks and a full range of stainless
steel or integrated appliances making this the ideal space
for relaxing or entertaining.

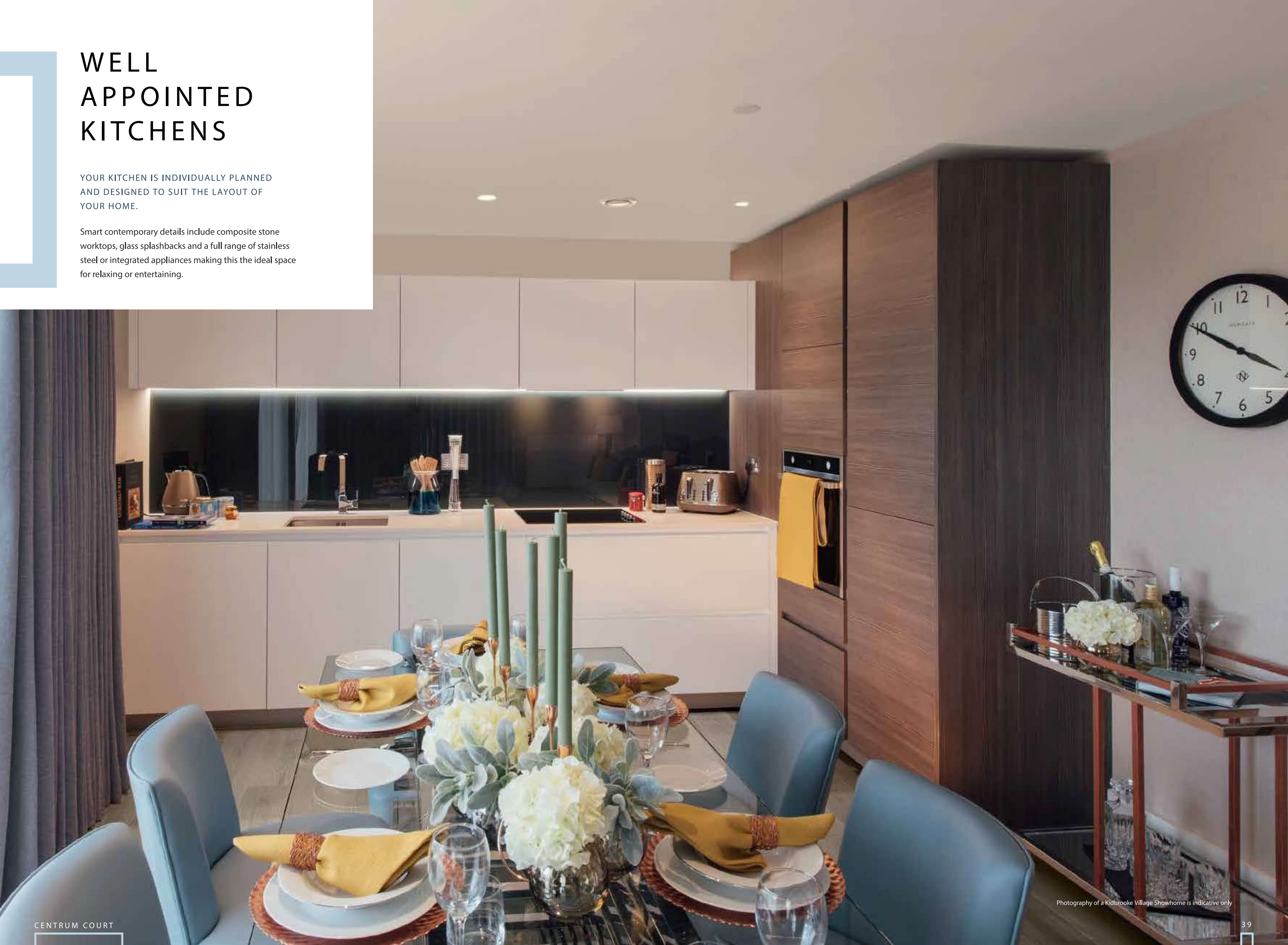

Photography of a Kidbrooke Village Showhome is indicative only

RELAX AND UNWIND

DESIGNED FOR CONTEMPORARY LIVING, ESCAPE THE WORLD OUTSIDE AND RELAX IN COMFORT.

Step into your luxurious bedroom, with soft carpets and stylish fitted wardrobe to the master bedroom, meeting all your needs for comfort and convenience.

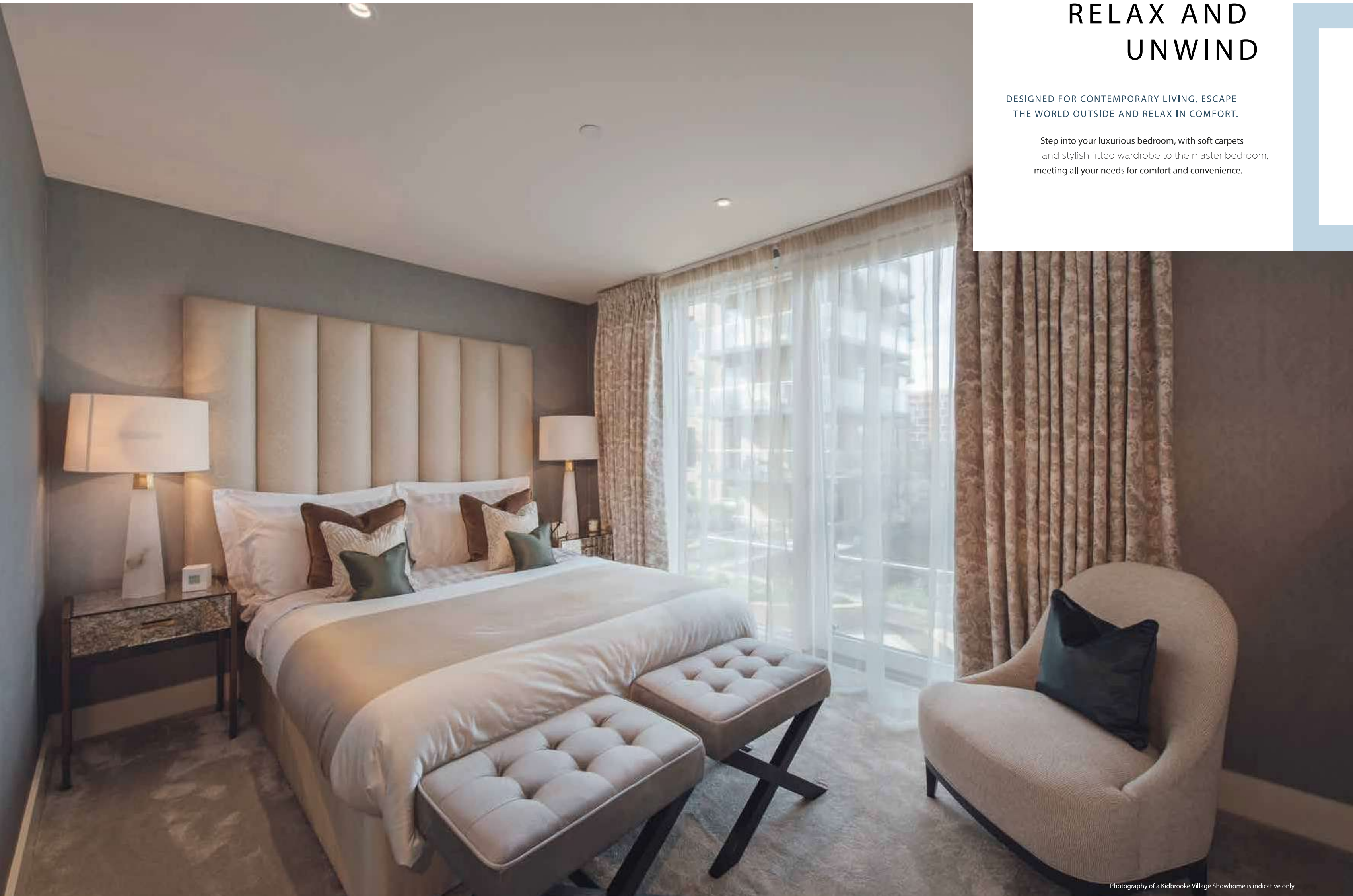

Photography of a Kidbrooke Village Showhome is indicative only



CONTEMPORARY BATHROOMS

LEAVE EVERYDAY STRESSES BEHIND
IN A LUXURIANT 'BOUTIQUE-HOTEL'
STYLE BATHROOM.

Enjoy chic shower rooms and en suites with
stylish modern features such as large format
wall and floor tiles and chrome taps, perfect for
relaxing or getting ready for the day ahead.



SPECIFICATION

TYPICAL SPECIFICATION OF 2 AND 3 BEDROOM APARTMENTS.
1 BEDROOM APARTMENT SPECIFICATION MAY VARY.

KITCHENS

- Individually designed layouts
- Stone effect worktops with full height glass splashback below wall cabinets
- Handle-free doors
- Stainless steel under mount single bowl sink
- Chrome finish monobloc tap
- Energy efficient ceiling down lighters and low voltage LED lights below wall cabinets
- Concealed white multi-gang appliance panel
- Stainless steel power sockets above worktop
- SMEG black glass ceramic hob
- Telescopic recirculating extractor hood
- SMEG stainless steel fronted multi function oven
- SMEG integrated fridge / freezer
- SMEG integrated multi-function dishwasher
- SMEG stainless steel fronted integrated microwave (3 bed apartments only)
- Space saving recycling bins to undersink unit

INTERIOR FINISHES

- Timber veneer finish to full height entrance door
- Matt emulsion paint finish to walls and ceilings
- White painted internal doors
- White painted skirtings and architraves
- Windows pre-finished white internally
- Polished chrome door handles throughout
- Amtico flooring to living area, hallway and kitchen (light or dark options)
- Carpet to bedrooms (colour options available)

BATHROOMS / SHOWER ROOMS

- White single ended bath with veneered bath panel and glazed hinged bath screen
- Chrome exposed thermostatic bath / shower mixer above bath with showerhead, hose and rail
- Chrome exposed thermostatic shower mixer with showerhead, hose to shower rooms
- Shower tray with frameless hinged door and panel to shower rooms
- Semi recessed white square wash hand basin with chrome monobloc mixer tap
- White wall mounted WC pan with push button dual-flush and concealed cistern
- Chrome effect ladder style thermostatically controlled towel rail to bathrooms and shower rooms
- Large format ceramic tiling to floors and walls
- Full height wall tiling to the bath or shower wet areas, and walls behind WC and basin, all other wall areas to be painted
- Glass splashback below wall cabinet
- Fitted wall cabinet with single mirrored door, shelves, and shaver socket above basin with low voltage LED strip lights below wall cabinet
- Extract ventilation to outside
- Energy efficient downlighters

ELECTRICAL FITTINGS

- Energy efficient ceiling downlighters throughout
- Lighting to hall cupboards
- Television (terrestrial and Sky Q) points to principal living room and master bedroom
- Telephone point to living room and master bedroom
- White electrical sockets and switches throughout (except kitchen above worktop)
- Home office facility

HEATING

- Heating and hot water to all apartments from communal system with metered water supply to each apartment
- Radiator panel heating throughout
- Plumbing for washer / dryer within vented utility cupboard

BALCONIES / TERRACES

- Well proportioned balconies with glass or steel balustrade and timber decking or paving finish where indicated.

SECURITY

- Audio / visual entry via TV and domestic mobile phone linked to entrance door (may require telephone connection and call waiting service to be provided by purchaser)
- Mains supply smoke detectors, heat detectors and sprinklers provided
- 'Secure By Design' standards to apartment entrance doors to meet National Police 'Design Out Crime' standards
- Lockable windows
- 24-hr concierge service and monitored CCTV

PEACE OF MIND

- 999 year lease
- All homes benefit from 10-year build warranty

CAR PARKING

- Limited car parking spaces subject to separate negotiation

LIFTS

- Passenger lifts serving each core and all levels

MAIN ENTRANCE & LIFT LOBBIES

- Glass doors and feature finishes to main apartment block entrance and lift lobbies
- Carpeted floors and painted walls to levels above podium
- Tiled floors and painted walls to car park and podium levels

EXTERNAL COMMUNAL AREAS

- Landscaped podium garden
- A managing agent will administer the effective operation and maintenance of communal facilities

OPTIONS & UPGRADES AVAILABLE

- See Sales Consultant for details (Options and upgrades subject to cut off dates)

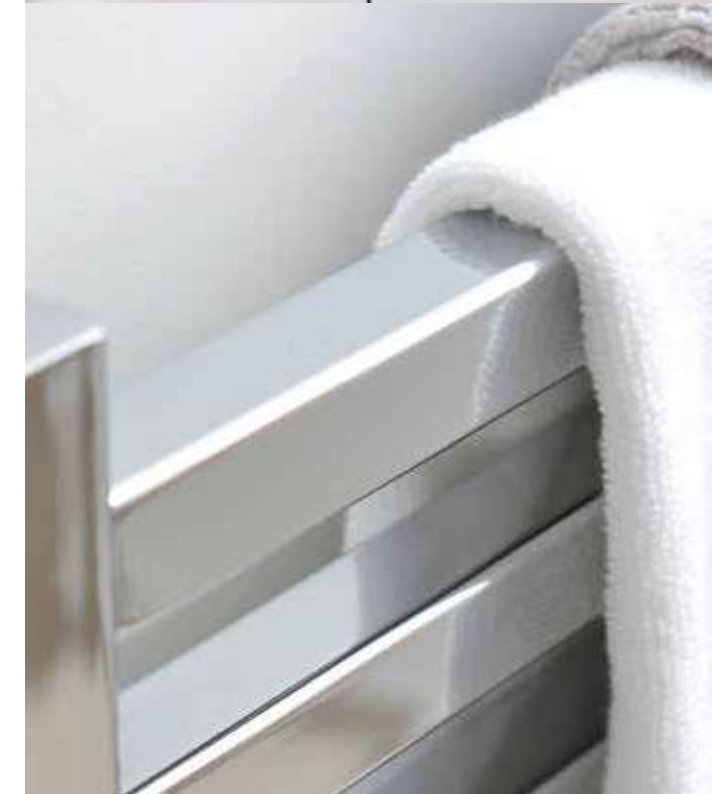



TURYAP[®]
UK

FLOORPLANS

A SELECTION OF 1, 2 & 3 BEDROOM
APARTMENTS, PENTHOUSES
& TOWNHOUSES

SITEPLAN



APARTMENTS

BLOCK D1							BLOCK D1						
PLOT NUMBER	BEDS	SINGLE / DUPLEX / TRIPLEX	NIA SQ M	NIA SQ FT	FLOOR	PAGE NO.	PLOT NUMBER	BEDS	SINGLE / DUPLEX / TRIPLEX	NIA SQ M	NIA SQ FT	FLOOR	PAGE NO.
D1-2-03	1	SINGLE	50.0	538	2	59	D1-4-05	2	SINGLE	62.0	667	4	73
D1-3-03	1	SINGLE	50.0	538	3	59	D1-5-01	2	SINGLE	71.0	764	5	72
D1-3-06	1	SINGLE	51.0	549	3	67	D1-5-02	2	SINGLE	71.0	764	5	72
D1-4-03	1	SINGLE	50.0	538	4	59	D1-5-04	2	SINGLE	62.0	667	5	74
D1-4-06	1	SINGLE	51.0	549	4	58	D1-5-05	2	SINGLE	62.0	667	5	74
D1-5-03	1	SINGLE	50.0	538	5	59	D1-6-01	2	SINGLE	71.0	764	6	71
D1-5-06	1	SINGLE	51.0	549	5	58	D1-6-02	2	SINGLE	71.0	764	6	71
D1-6-03	1	SINGLE	50.0	538	6	59	D1-6-04	2	SINGLE	62.0	667	6	73
D1-6-06	1	SINGLE	51.0	549	6	58	D1-6-05	2	SINGLE	62.0	667	6	73
D1-7-03	1	SINGLE	50.0	538	7	59	D1-7-01	2	SINGLE	71.0	764	7	71
D1-7-06	1	SINGLE	51.0	549	7	58	D1-7-02	2	SINGLE	71.0	764	7	71
D1-8-03	1	SINGLE	50.0	538	8	59	D1-7-04	2	SINGLE	62.0	667	7	73
D1-8-05	1	SINGLE	51.0	549	8	58	D1-7-05	2	SINGLE	62.0	667	7	73
D1-9-03	1	SINGLE	50.0	538	9	59	D1-8-01	2	SINGLE	71.0	764	8	72
D1-9-05	1	SINGLE	51.0	549	9	58	D1-8-02	2	SINGLE	71.0	764	8	72
D1-10-03	1	SINGLE	52.0	560	10	65	D1-9-01	2	SINGLE	71.0	764	9	71
D1-10-04	1	SINGLE	52.0	560	10	65	D1-9-02	2	SINGLE	71.0	764	9	71
D1-2-02	2	SINGLE	71.0	764	2	72	D1-10-01	2	SINGLE	71.0	764	10	71
D1-2-05	2	SINGLE	80.0	861	2	79	D1-10-02	2	SINGLE	71.0	764	10	71
D1-3-01	2	SINGLE	71.0	764	3	71	D1-11-01	2	SINGLE	64.0	689	11	88
D1-3-02	2	SINGLE	71.0	764	3	71	D1-2-01	3	SINGLE	92.0	990	2	93
D1-4-01	2	SINGLE	71.0	764	4	71	D1-8-04	3	SINGLE	115.0	1238	8	89
D1-4-02	2	SINGLE	71.0	764	4	71							
D1-4-04	2	SINGLE	62.0	667	4	73							



Building D1-6-01 Apartment
Floor level

Photography of a previous Kidbrooke Village Showhome is indicative only and for illustration purposes only

APARTMENTS

BLOCK D2							BLOCK D2						
PLOT NUMBER	BEDS	SINGLE / DUPLEX / TRIPLEX	NIA SQ M	NIA SQ FT	FLOOR	PAGE NO.	PLOT NUMBER	BEDS	SINGLE / DUPLEX / TRIPLEX	NIA SQ M	NIA SQ FT	FLOOR	PAGE NO.
D2-2-05	1	SINGLE	51.0	549	2	66	D2-5-01	2	SINGLE	71.0	764	5	71
D2-3-03	1	SINGLE	51.0	549	3	67	D2-5-02	2	SINGLE	71.0	764	5	71
D2-3-06	1	SINGLE	51.0	549	3	58	D2-5-04	2	SINGLE	62.0	667	5	73
D2-4-03	1	SINGLE	51.0	549	4	58	D2-5-05	2	SINGLE	62.0	667	5	73
D2-4-06	1	SINGLE	51.0	549	4	58	D2-6-01	2	SINGLE	71.0	764	6	72
D2-5-03	1	SINGLE	51.0	549	5	58	D2-6-02	2	SINGLE	71.0	764	6	72
D2-5-06	1	SINGLE	51.0	549	5	58	D2-6-04	2	SINGLE	62.0	667	6	74
D2-6-03	1	SINGLE	51.0	549	6	58	D2-6-05	2	SINGLE	62.0	667	6	74
D2-6-06	1	SINGLE	51.0	549	6	58	D2-7-01	2	SINGLE	71.0	764	7	71
D2-7-03	1	SINGLE	51.0	549	7	58	D2-7-02	2	SINGLE	71.0	764	7	71
D2-7-06	1	SINGLE	51.0	549	7	58	D2-7-04	2	SINGLE	62.0	667	7	73
D2-8-03	1	SINGLE	51.0	549	8	58	D2-7-05	2	SINGLE	62.0	667	7	73
D2-8-06	1	SINGLE	51.0	549	8	58	D2-8-01	2	SINGLE	71.0	764	8	71
D2-9-03	1	SINGLE	51.0	549	9	58	D2-8-02	2	SINGLE	71.0	764	8	71
D2-9-06	1	SINGLE	51.0	549	9	58	D2-8-04	2	SINGLE	62.0	667	8	73
D2-10-03	1	SINGLE	51.0	549	10	58	D2-8-05	2	SINGLE	62.0	667	8	73
D2-10-05	1	SINGLE	51.0	549	10	58	D2-9-01	2	SINGLE	71.0	764	9	72
D2-11-03	1	SINGLE	51.0	549	11	58	D2-9-02	2	SINGLE	71.0	764	9	72
D2-11-05	1	SINGLE	51.0	549	11	58	D2-9-04	2	SINGLE	62.0	667	9	74
D2-12-03	1	SINGLE	52.0	560	12	65	D2-9-05	2	SINGLE	62.0	667	9	74
D2-12-04	1	SINGLE	52.0	560	12	65	D2-10-01	2	SINGLE	71.0	764	10	71
D2-2-01	2	SINGLE	71.0	764	2	76	D2-10-02	2	SINGLE	71.0	764	10	71
D2-2-03	2	SINGLE	80.0	861	2	80	D2-11-01	2	SINGLE	71.0	764	11	71
D2-2-04	2	SINGLE	62.0	667	2	78	D2-11-02	2	SINGLE	71.0	764	11	71
D2-3-01	2	SINGLE	71.0	764	3	72	D2-12-01	2	SINGLE	71.0	764	12	72
D2-3-02	2	SINGLE	71.0	764	3	72	D2-12-02	2	SINGLE	71.0	764	12	72
D2-4-01	2	SINGLE	71.0	764	4	71	D2-13-01	2	SINGLE	64.0	689	13	88
D2-4-02	2	SINGLE	71.0	764	4	71	D2-2-02	3	SINGLE	92.0	990	2	94
D2-4-04	2	SINGLE	62.0	667	4	73	D2-10-04	3	SINGLE	118.0	1270	10	101
D2-4-05	2	SINGLE	62.0	667	4	73							



Photography of a previous Kidbrooke Village Showhome is indicative only and for illustration purposes only

Building D1-6-01 Apartment
Floor level

APARTMENTS

BLOCK D3							BLOCK D3						
PLOT NUMBER	BEDS	SINGLE / DUPLEX / TRIPLEX	NIA SQ M	NIA SQ FT	FLOOR	PAGE NO.	PLOT NUMBER	BEDS	SINGLE / DUPLEX / TRIPLEX	NIA SQ M	NIA SQ FT	FLOOR	PAGE NO.
D3-2-01	1	SINGLE	51.0	549	2	58	D3-6-06	2	SINGLE	71.0	764	6	71
D3-2-02	1	SINGLE	55.0	592	2	61	D3-6-07	2	SINGLE	71.0	764	6	71
D3-3-01	1	SINGLE	51.0	549	3	58	D3-7-06	2	SINGLE	71.0	764	7	71
D3-3-02	1	SINGLE	55.0	592	3	61	D3-7-07	2	SINGLE	71.0	764	7	71
D3-3-04	1	SINGLE	57.0	614	3	60	D3-8-02	2	SINGLE	62.0	667	8	77
D3-3-05	1	SINGLE	51.0	549	3	67	D3-8-03	2	SINGLE	62.0	667	8	77
D3-4-01	1	SINGLE	51.0	549	4	58	D3-8-05	2	SINGLE	71.0	764	8	72
D3-4-02	1	SINGLE	55.0	592	4	61	D3-8-06	2	SINGLE	71.0	764	8	72
D3-4-04	1	SINGLE	57.0	614	4	60	D3-9-02	2	SINGLE	62.0	667	9	73
D3-4-05	1	SINGLE	51.0	549	4	58	D3-9-03	2	SINGLE	62.0	667	9	73
D3-5-01	1	SINGLE	51.0	549	5	58	D3-9-05	2	SINGLE	71.0	764	9	71
D3-5-02	1	SINGLE	55.0	592	5	61	D3-9-06	2	SINGLE	71.0	764	9	71
D3-5-04	1	SINGLE	57.0	614	5	60	D3-10-02	2	SINGLE	62.0	667	10	73
D3-5-05	1	SINGLE	51.0	549	5	58	D3-10-03	2	SINGLE	62.0	667	10	73
D3-6-01	1	SINGLE	51.0	549	6	58	D3-10-05	2	SINGLE	71.0	764	10	71
D3-6-02	1	SINGLE	55.0	592	6	61	D3-10-06	2	SINGLE	71.0	764	10	71
D3-6-04	1	SINGLE	57.0	614	6	60	D3-11-02	2	SINGLE	62.0	667	11	73
D3-6-05	1	SINGLE	51.0	549	6	58	D3-11-03	2	SINGLE	62.0	667	11	73
D3-7-01	1	SINGLE	51.0	549	7	58	D3-11-05	2	SINGLE	71.0	764	11	71
D3-7-02	1	SINGLE	55.0	592	7	61	D3-11-06	2	SINGLE	71.0	764	11	71
D3-7-04	1	SINGLE	57.0	614	7	60	D3-12-02	2	SINGLE	62.0	667	12	74
D3-7-05	1	SINGLE	51.0	549	7	58	D3-12-03	2	SINGLE	62.0	667	12	74
D3-8-01	1	SINGLE	51.0	549	8	58	D3-12-05	2	SINGLE	71.0	764	12	72
D3-8-04	1	SINGLE	51.0	549	8	58	D3-12-06	2	SINGLE	71.0	764	12	72
D3-9-01	1	SINGLE	51.0	549	9	58	D3-13-02	2	SINGLE	62.0	667	13	73
D3-9-04	1	SINGLE	51.0	549	9	58	D3-13-03	2	SINGLE	62.0	667	13	73
D3-10-01	1	SINGLE	51.0	549	10	58	D3-13-05	2	SINGLE	71.0	764	13	71
D3-10-04	1	SINGLE	51.0	549	10	58	D3-13-06	2	SINGLE	71.0	764	13	71
D3-11-01	1	SINGLE	51.0	549	11	58	D3-14-02	2	SINGLE	62.0	667	14	73
D3-11-04	1	SINGLE	51.0	549	11	58	D3-14-03	2	SINGLE	62.0	667	14	73
D3-12-01	1	SINGLE	51.0	549	12	58	D3-14-05	2	SINGLE	71.0	764	14	71
D3-12-04	1	SINGLE	51.0	549	12	58	D3-14-06	2	SINGLE	71.0	764	14	71
D3-13-01	1	SINGLE	51.0	549	13	58	D3-15-02	2	SINGLE	62.0	667	15	73
D3-13-04	1	SINGLE	51.0	549	13	58	D3-15-03	2	SINGLE	62.0	667	15	73
D3-14-01	1	SINGLE	51.0	549	14	58	D3-15-05	2	SINGLE	71.0	764	15	71
D3-14-04	1	SINGLE	51.0	549	14	58	D3-15-06	2	SINGLE	71.0	764	15	71
D3-15-01	1	SINGLE	51.0	549	15	58	D3-2-03	3	SINGLE	99.0	1066	2	98
D3-15-04	1	SINGLE	51.0	549	15	58	D3-2-05	3	SINGLE	92.0	990	2	95
D3-2-04	2	SINGLE	75.0	807	2	82	D3-3-03	3	SINGLE	99.0	1066	3	90
D3-2-06	2	SINGLE	71.0	764	2	71	D3-4-03	3	SINGLE	99.0	1066	4	90
D3-3-06	2	SINGLE	71.0	764	3	71	D3-5-03	3	SINGLE	99.0	1066	5	90
D3-3-07	2	SINGLE	71.0	764	3	71	D3-6-03	3	SINGLE	99.0	1066	6	90
D3-4-06	2	SINGLE	71.0	764	4	72	D3-7-03	3	SINGLE	99.0	1066	7	90
D3-4-07	2	SINGLE	71.0	764	4	72							
D3-5-06	2	SINGLE	71.0	764	5	71							
D3-5-07	2	SINGLE	71.0	764	5	71							

Building D1-6-01 Apartment
Floor level

APARTMENTS

BLOCK D4							BLOCK D4						
PLOT NUMBER	BEDS	SINGLE / DUPLEX / TRIPLEX	NIA SQ M	NIA SQ FT	FLOOR	PAGE NO.	PLOT NUMBER	BEDS	SINGLE / DUPLEX / TRIPLEX	NIA SQ M	NIA SQ FT	FLOOR	PAGE NO.
D4-2-03	1	SINGLE	52.0	560	2	70	D4-5-01	2	SINGLE	71.0	764	5	75
D4-2-04	1	SINGLE	52.0	560	2	69	D4-5-05	2	SINGLE	64.0	689	5	86
D4-2-05	1	SINGLE	50.0	538	2	68	D4-6-01	2	SINGLE	71.0	764	6	75
D4-2-07	1	SINGLE	52.0	560	2	63	D4-6-05	2	SINGLE	64.0	689	6	86
D4-3-03	1	SINGLE	52.0	560	3	64	D4-7-01	2	SINGLE	71.0	764	7	75
D4-3-04	1	SINGLE	52.0	560	3	62	D4-7-05	2	SINGLE	64.0	689	7	86
D4-3-07	1	SINGLE	52.0	560	3	63	D4-8-01	2	SINGLE	71.0	764	8	75
D4-4-03	1	SINGLE	52.0	560	4	64	D4-8-05	2	SINGLE	64.0	689	8	86
D4-4-04	1	SINGLE	52.0	560	4	62	D4-1U-02	3	SINGLE	101.0	1087	1U	99
D4-4-07	1	SINGLE	52.0	560	4	63	D4-2-02	3	SINGLE	106.0	1141	2	92
D4-5-03	1	SINGLE	52.0	560	5	64	D4-2-06	3	SINGLE	93.0	1001	2	100
D4-5-04	1	SINGLE	52.0	560	5	62	D4-3-02	3	SINGLE	106.0	1141	3	92
D4-5-07	1	SINGLE	52.0	560	5	63	D4-3-06	3	SINGLE	96.0	1033	3	91
D4-6-03	1	SINGLE	52.0	560	6	64	D4-4-02	3	SINGLE	106.0	1141	4	92
D4-6-04	1	SINGLE	52.0	560	6	62	D4-4-06	3	SINGLE	96.0	1033	4	91
D4-6-07	1	SINGLE	52.0	560	6	63	D4-5-02	3	SINGLE	106.0	1141	5	92
D4-7-03	1	SINGLE	52.0	560	7	64	D4-5-06	3	SINGLE	96.0	1033	5	91
D4-7-04	1	SINGLE	52.0	560	7	62	D4-6-02	3	SINGLE	106.0	1141	6	92
D4-7-07	1	SINGLE	52.0	560	7	63	D4-6-06	3	SINGLE	96.0	1033	6	91
D4-8-03	1	SINGLE	52.0	560	8	64	D4-7-02	3	SINGLE	106.0	1141	7	92
D4-8-04	1	SINGLE	52.0	560	8	62	D4-7-06	3	SINGLE	96.0	1033	7	91
D4-8-07	1	SINGLE	52.0	560	8	63	D4-8-02	3	SINGLE	106.0	1141	8	92
D4-1U-01	2	SINGLE	71.0	764	1U	75	D4-8-06	3	SINGLE	96.0	1033	8	91
D4-2-01	2	SINGLE	71.0	764	2	75							
D4-3-01	2	SINGLE	71.0	764	3	75							
D4-4-01	2	SINGLE	71.0	764	4	75							



Photography of a previous Kidbrooke Village Showhome is indicative only and for illustration purposes only

Building D1-6-01 Apartment
Floor level

APARTMENTS

BLOCK D5							BLOCK D5						
PLOT NUMBER	BEDS	SINGLE / DUPLEX / TRIPLEX	NIA SQ M	NIA SQ FT	FLOOR	PAGE NO.	PLOT NUMBER	BEDS	SINGLE / DUPLEX / TRIPLEX	NIA SQ M	NIA SQ FT	FLOOR	PAGE NO.
D5-2-03	1	SINGLE	50.0	538	2	59	D5-4-05	2	SINGLE	62.0	667	4	73
D5-3-03	1	SINGLE	50.0	538	3	59	D5-5-01	2	SINGLE	71.0	764	5	72
D5-3-06	1	SINGLE	51.0	549	3	67	D5-5-02	2	SINGLE	71.0	764	5	72
D5-4-03	1	SINGLE	50.0	538	4	59	D5-5-04	2	SINGLE	62.0	667	5	74
D5-4-06	1	SINGLE	51.0	549	4	58	D5-5-05	2	SINGLE	62.0	667	5	74
D5-5-03	1	SINGLE	50.0	538	5	59	D5-6-01	2	SINGLE	71.0	764	6	71
D5-5-06	1	SINGLE	51.0	549	5	58	D5-6-02	2	SINGLE	71.0	764	6	71
D5-6-03	1	SINGLE	50.0	538	6	59	D5-6-04	2	SINGLE	62.0	667	6	73
D5-6-06	1	SINGLE	51.0	549	6	58	D5-6-05	2	SINGLE	62.0	667	6	73
D5-7-03	1	SINGLE	50.0	538	7	59	D5-7-01	2	SINGLE	71.0	764	7	71
D5-7-06	1	SINGLE	51.0	549	7	58	D5-7-02	2	SINGLE	71.0	764	7	71
D5-8-03	1	SINGLE	50.0	538	8	59	D5-7-04	2	SINGLE	62.0	667	7	73
D5-8-06	1	SINGLE	51.0	549	8	58	D5-7-05	2	SINGLE	62.0	667	7	73
D5-9-03	1	SINGLE	50.0	538	9	59	D5-8-01	2	SINGLE	71.0	764	8	72
D5-9-06	1	SINGLE	51.0	549	9	58	D5-8-02	2	SINGLE	71.0	764	8	72
D5-1L-01	2	SINGLE	75.0	807	1L	84	D5-8-04	2	SINGLE	62.0	667	8	74
D5-1U-01	2	SINGLE	75.0	807	1U	84	D5-8-05	2	SINGLE	62.0	667	8	74
D5-1U-02	2	SINGLE	71.0	764	1U	71	D5-9-01	2	SINGLE	71.0	764	9	71
D5-1U-03	2	SINGLE	72.0	775	1U	85	D5-9-02	2	SINGLE	71.0	764	9	71
D5-G-01	2	SINGLE	64.0	689	G	83	D5-9-04	2	SINGLE	62.0	667	9	73
D5-2-02	2	SINGLE	71.0	764	2	72	D5-9-05	2	SINGLE	62.0	667	9	73
D5-2-05	2	SINGLE	80.0	861	2	81	D5-1L-02	3	SINGLE	92.0	990	1L	96
D5-3-01	2	SINGLE	71.0	764	3	71	D5-2-01	3	SINGLE	92.0	990	2	97
D5-3-02	2	SINGLE	71.0	764	3	71	D5-10-04	3	SINGLE	118.0	1270	10	101
D5-4-01	2	SINGLE	71.0	764	4	71							
D5-4-02	2	SINGLE	71.0	764	4	71							



Building D1-6-01 Apartment
Floor level

PODIUM APARTMENTS & TOWNHOUSES

PODIUM APARTMENTS							TOWNHOUSES						
PLOT NUMBER	BEDS	SINGLE / DUPLEX / TRIPLEX	NIA SQ M	NIA SQ FT	FLOOR	PAGE NO.	PLOT NUMBER	BEDS	SINGLE / DUPLEX / TRIPLEX	NIA SQ M	NIA SQ FT	FLOOR	PAGE NO.
DP-2-01	2	SINGLE	67.0	721	2	87	D-G-05	2	DUPLEX	90.0	969	G/1L	128
DP-2-02	2	SINGLE	67.0	721	2	87	D-G-04	3	DUPLEX	106.0	1141	G/1L	134
DP-2-03	2	SINGLE	67.0	721	2	87	D-G-01	3	TRIPLEX	127.0	1367	G/1L/1U	130
DP-2-04	2	SINGLE	67.0	721	2	87	D-G-02	3	TRIPLEX	127.0	1367	G/1L/1U	130
							D-G-03	3	TRIPLEX	102.0	1098	G/1L/1U	132

PENTHOUSES

BLOCK D1 PENTHOUSES							BLOCK D3 PENTHOUSES						
PLOT NUMBER	BEDS	SINGLE / DUPLEX / TRIPLEX	NIA SQ M	NIA SQ FT	FLOOR	PAGE NO.	PLOT NUMBER	BEDS	SINGLE / DUPLEX / TRIPLEX	NIA SQ M	NIA SQ FT	FLOOR	PAGE NO.
D1-11-04	2	DUPLEX	98.0	1055	11/12	104	D3-16-01	2	DUPLEX	103.0	1109	16/17	108
D1-12-01	2	SINGLE	64.0	689	12	110	D3-16-04	2	DUPLEX	103.0	1109	16/17	108
D1-9-04	3	SINGLE	101.0	1087	9	111	D3-16-02	3	DUPLEX	112.0	1206	16/17	120
D1-11-02	3	DUPLEX	110.0	1184	11/12	114	D3-16-03	3	DUPLEX	112.0	1206	16/17	120
D1-11-03	3	DUPLEX	106.0	1141	11/12	112	D3-16-05	3	DUPLEX	112.0	1206	16/17	116
							D3-16-06	3	DUPLEX	112.0	1206	16/17	116

BLOCK D2 PENTHOUSES							BLOCK D5 PENTHOUSES						
PLOT NUMBER	BEDS	SINGLE / DUPLEX / TRIPLEX	NIA SQ M	NIA SQ FT	FLOOR	PAGE NO.	PLOT NUMBER	BEDS	SINGLE / DUPLEX / TRIPLEX	NIA SQ M	NIA SQ FT	FLOOR	PAGE NO.
D2-13-04	2	DUPLEX	98.0	1055	13/14	104	D5-10-03	2	DUPLEX	100.0	1076	10/11	106
D2-14-01	2	SINGLE	64.0	689	14	110	D5-10-05	2	DUPLEX	100.0	1076	10/11	106
D2-11-04	3	SINGLE	118.0	1270	11	122	D5-10-01	3	DUPLEX	112.0	1206	10/11	118
D2-13-02	3	DUPLEX	110.0	1184	13/14	114	D5-10-02	3	DUPLEX	112.0	1206	10/11	118
D2-13-03	3	DUPLEX	106.0	1141	13/14	112	D5-11-04	3	SINGLE	118.0	1270	11	122



CGI of a Centrum Court apartment, indicative only

Building D1-6-01 Apartment
Floor level



TURYAP[®]
UK

APARTMENTS

A SELECTION OF
1, 2 & 3 BEDROOM APARTMENTS

1 BEDROOM APARTMENTS

BLOCKS ONE, TWO, THREE & FIVE

Plot Numbers										
D1-4-06*	D2-3-06*	D2-6-06*	D2-9-06*	D3-3-01 †	D3-6-05*	D3-9-04*	D3-12-04*	D3-15-04*	D5-9-06*	
D1-5-06*	D2-4-03	D2-7-03	D2-10-03	D3-4-01 †	D3-7-01 †	D3-10-01 †	D3-13-01 †	D5-4-06*		
D1-6-06*	D2-4-06*	D2-7-06*	D2-10-05*	D3-4-05*	D3-7-05*	D3-10-04*	D3-13-04*	D5-5-06*		
D1-7-06*	D2-5-03	D2-8-03	D2-11-03	D3-5-01 †	D3-8-01 †	D3-11-01 †	D3-14-01 †	D5-6-06*		
D1-8-05*	D2-5-06*	D2-8-06*	D2-11-05*	D3-5-05*	D3-8-04*	D3-11-04*	D3-14-04*	D5-7-06*		
D1-9-05*	D2-6-03	D2-9-03	D3-2-01 †	D3-6-01 †	D3-9-01 †	D3-12-01 †	D3-15-01 †	D5-8-06*		



LOCATOR

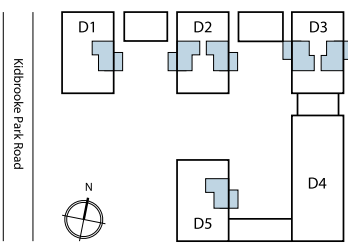

ROOM DIMENSIONS

Living/Dining/Kitchen	6.70m x 3.66m	22'0" x 12'0"
Bedroom	4.04m x 2.80m	13'3" x 9'2"
Balcony	3.37m x 1.50m	11'1" x 4'11"
Total internal area:	51.0 sq m	549 sq ft

1 BEDROOM APARTMENTS

BLOCKS ONE & FIVE

Plot Numbers					
D1-2-03	D1-5-03	D1-8-03	D5-3-03	D5-6-03	D5-9-03
D1-3-03	D1-6-03	D1-9-03	D5-4-03	D5-7-03	
D1-4-03	D1-7-03	D5-2-03	D5-5-03	D5-8-03	



LOCATOR

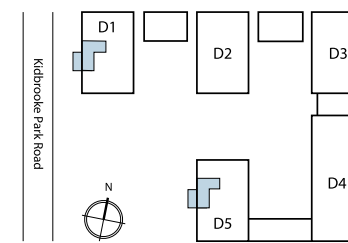

ROOM DIMENSIONS

Living/Dining/Kitchen	6.70m x 3.66m	22'0" x 12'0"
Bedroom	4.04m x 2.80m	13'3" x 9'2"
Balcony	3.40m x 1.50m	11'1" x 4'11"
Total internal area:	50.0 sq m	538 sq ft

* Plot is handed
† Plot is rotated

C Structural Column WM Provision for washing machine HIU Heat interface unit ◀ ▶ Measurement points

TYPE: 2A

C Structural Column WM Provision for washing machine HIU Heat interface unit ◀ ▶ Measurement points

TYPE: 2C

These layouts are not to scale and provide approximate measurements and are indicative only. Dimensions, which are taken from the indicated points of measurements are for guidance only and are not intended to be used for carpet sizes, appliance space or items of furniture. Apartment areas are provided as gross internal areas under the RICS measuring practice. Due to the unique design of these homes, measurements and areas may vary within a tolerance of 5%. Kitchen layouts are indicative only and are subject to change. All garden exterior dimensions and areas are approximate and may vary within a tolerance of 10% subject to detailed design.

These layouts are not to scale and provide approximate measurements and are indicative only. Dimensions, which are taken from the indicated points of measurements are for guidance only and are not intended to be used for carpet sizes, appliance space or items of furniture. Apartment areas are provided as gross internal areas under the RICS measuring practice. Due to the unique design of these homes, measurements and areas may vary within a tolerance of 5%. Kitchen layouts are indicative only and are subject to change. All garden exterior dimensions and areas are approximate and may vary within a tolerance of 10% subject to detailed design.

1 BEDROOM APARTMENTS BLOCK THREE

Plot Numbers
D3-3-04 D3-4-04 D3-5-04 D3-6-04 D3-7-04



LOCATOR

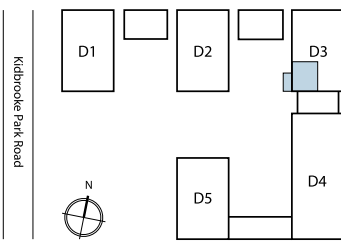

ROOM DIMENSIONS

Living/Dining/Kitchen	7.49m x 4.12m	24'7" x 13'6"
Bedroom	3.65m x 3.45m	12'0" x 11'4"
Balcony	3.38m x 1.50m	11'1" x 4'11"
Total internal area:	57.0 sq m	614 sq ft

C Structural Column WM Provision for washing machine HIU Heat interface unit ◀ ▶ Measurement points

TYPE: 8A

These layouts are not to scale and provide approximate measurements and are indicative only. Dimensions, which are taken from the indicated points of measurements are for guidance only and are not intended to be used for carpet sizes, appliance space or items of furniture. Apartment areas are provided as gross internal areas under the RICS measuring practice. Due to the unique design of these homes, measurements and areas may vary within a tolerance of 5%. All garden exterior dimensions and areas are approximate and may vary within a tolerance of 10% subject to detailed design.

1 BEDROOM APARTMENTS BLOCK THREE

Plot Numbers
D3-2-02 D3-3-02 D3-4-02 D3-5-02 D3-6-02 D3-7-02



LOCATOR

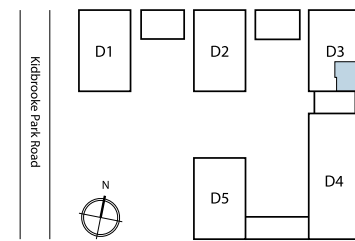

ROOM DIMENSIONS

Living/Dining/Kitchen	6.89m x 4.12m	22'10" x 13'6"
Bedroom	3.65m x 3.45m	12'0" x 11'4"
Balcony	3.38m x 1.50m	11'1" x 4'11"
Total internal area:	55.0 sq m	592 sq ft

C Structural Column WM Provision for washing machine HIU Heat interface unit ▶ ◀ Measurement points

TYPE: 8B

These layouts are not to scale and provide approximate measurements and are indicative only. Dimensions, which are taken from the indicated points of measurements are for guidance only and are not intended to be used for carpet sizes, appliance space or items of furniture. Apartment areas are provided as gross internal areas under the RICS measuring practice. Due to the unique design of these homes, measurements and areas may vary within a tolerance of 5%. Kitchen layouts are indicative only and are subject to change. All garden exterior dimensions and areas are approximate and may vary within a tolerance of 10% subject to detailed design.

1 BEDROOM APARTMENTS BLOCK FOUR

Plot Numbers
D4-3-04 D4-4-04 D4-5-04 D4-6-04 D4-7-04 D4-8-04



1 BEDROOM APARTMENTS BLOCK FOUR

Plot Numbers
D4-2-07 D4-3-07 D4-4-07 D4-5-07 D4-6-07 D4-7-07 D4-8-07



LOCATOR

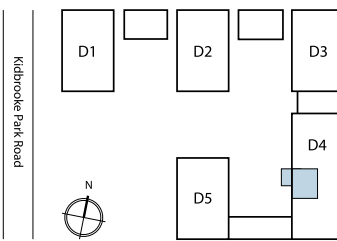

ROOM DIMENSIONS

Living/Dining/Kitchen	6.46m x 4.38m	21'3" x 14'5"
Bedroom	4.29m x 3.41m	14'1" x 11'2"
Balcony	3.34m x 1.57m	11'0" x 5'1"
Total internal area:	52.0 sq m	560 sq ft

LOCATOR

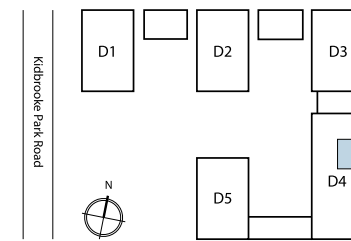

ROOM DIMENSIONS

Living/Dining/Kitchen	6.62m x 4.39m	21'9" x 14'5"
Bedroom	4.44m x 3.28m	14'7" x 10'9"
Balcony	3.39m x 1.96m	11'2" x 6'5"
Total internal area:	52.0 sq m	560 sq ft

C Structural Column WM Provision for washing machine HIU Heat interface unit ◀ ▶ Measurement points

TYPE: 15B

These layouts are not to scale and provide approximate measurements and are indicative only. Dimensions, which are taken from the indicated points of measurements are for guidance only and are not intended to be used for carpet sizes, appliance space or items of furniture. Apartment areas are provided as gross internal areas under the RICS measuring practice. Due to the unique design of these homes, measurements and areas may vary within a tolerance of 5%. Kitchen layouts are indicative only and are subject to change. All garden exterior dimensions and areas are approximate and may vary within a tolerance of 10% subject to detailed design.

C Structural Column WM Provision for washing machine HIU Heat interface unit ▶ ◀ Measurement points

TYPE: 16

These layouts are not to scale and provide approximate measurements and are indicative only. Dimensions, which are taken from the indicated points of measurements are for guidance only and are not intended to be used for carpet sizes, appliance space or items of furniture. Apartment areas are provided as gross internal areas under the RICS measuring practice. Due to the unique design of these homes, measurements and areas may vary within a tolerance of 5%. Kitchen layouts are indicative only and are subject to change. All garden exterior dimensions and areas are approximate and may vary within a tolerance of 10% subject to detailed design.

1 BEDROOM APARTMENTS BLOCK FOUR

Plot Numbers
D4-3-03 D4-4-03 D4-5-03 D4-6-03 D4-7-03 D4-8-03



LOCATOR

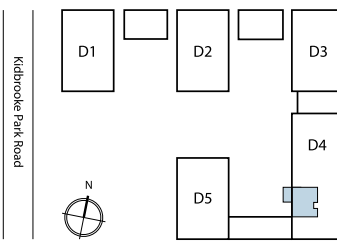

ROOM DIMENSIONS

Living/Dining/Kitchen	6.46m x 4.17m	21'3" x 13'8"
Bedroom	3.80m x 3.39m	12'6" x 11'2"
Balcony	3.34m x 1.55m	10'0" x 5'1"
Total internal area:	52.0 sq m	560 sq ft

C Structural Column WM Provision for washing machine HIU Heat interface unit ◀ ▶ Measurement points

TYPE: 20B

These layouts are not to scale and provide approximate measurements and are indicative only. Dimensions, which are taken from the indicated points of measurements are for guidance only and are not intended to be used for carpet sizes, appliance space or items of furniture. Apartment areas are provided as gross internal areas under the RICS measuring practice. Due to the unique design of these homes, measurements and areas may vary within a tolerance of 5%. All garden exterior dimensions and areas are approximate and may vary within a tolerance of 10% subject to detailed design.

1 BEDROOM APARTMENTS BLOCKS ONE & TWO

Plot Numbers
D1-10-03 D1-10-04* D2-12-03 D2-12-04*



LOCATOR

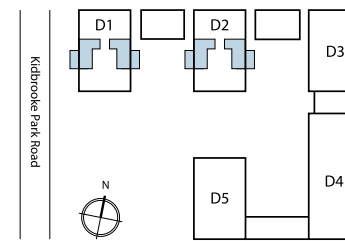

ROOM DIMENSIONS

Living/Dining/Kitchen	6.70m x 3.54m	22'0" x 11'8"
Bedroom	3.93m x 2.89m	12'11" x 9'6"
Balcony	3.40m x 1.50m	11'1" x 4'11"
Total internal area:	52.0 sq m	560 sq ft

* Plot is handed

C Structural Column WM Provision for washing machine HIU Heat interface unit ▶ Measurement points

TYPE: 2B

These layouts are not to scale and provide approximate measurements and are indicative only. Dimensions, which are taken from the indicated points of measurements are for guidance only and are not intended to be used for carpet sizes, appliance space or items of furniture. Apartment areas are provided as gross internal areas under the RICS measuring practice. Due to the unique design of these homes, measurements and areas may vary within a tolerance of 5%. All garden exterior dimensions and areas are approximate and may vary within a tolerance of 10% subject to detailed design.

1 BEDROOM APARTMENT BLOCK TWO

Plot Number
D2-2-05



LOCATOR

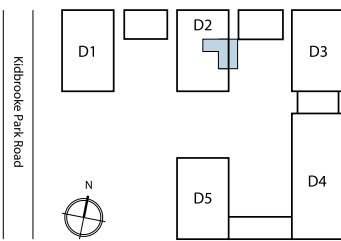

ROOM DIMENSIONS

Living/Dining/Kitchen	6.70m x 3.66m	22'0" x 12'0"
Bedroom	4.04m x 2.80m	13'3" x 9'2"
Terrace	10.26m x 2.37m	33'8" x 7'8"
Total internal area:	51.0 sq m	549 sq ft

C Structural Column WM Provision for washing machine HIU Heat interface unit ◀ ▶ Measurement points

TYPE: 2D

These layouts are not to scale and provide approximate measurements and are indicative only. Dimensions, which are taken from the indicated points of measurements are for guidance only and are not intended to be used for carpet sizes, appliance space or items of furniture. Apartment areas are provided as gross internal areas under the RICS measuring practice. Due to the unique design of these homes, measurements and areas may vary within a tolerance of 5%. All garden exterior dimensions and areas are approximate and may vary within a tolerance of 10% subject to detailed design.

1 BEDROOM APARTMENTS BLOCKS ONE, TWO, THREE & FIVE

Plot Numbers
D1-3-06* D2-3-03 D3-3-05* D5-3-06*



LOCATOR

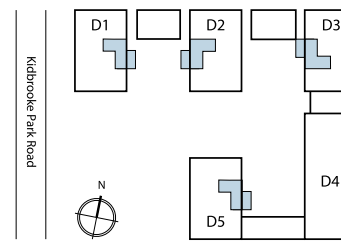

ROOM DIMENSIONS

Living/Dining/Kitchen	6.70m x 3.66m	22'0" x 12'0"
Bedroom	4.04m x 2.80m	13'3" x 9'2"
Balcony	3.40m x 1.50m	11'2" x 4'11"
Total internal area:	51.0 sq m	549 sq ft

* Plot is handed

C Structural Column WM Provision for washing machine HIU Heat interface unit ◀ ▶ Measurement points

TYPE: 2E

These layouts are not to scale and provide approximate measurements and are indicative only. Dimensions, which are taken from the indicated points of measurements are for guidance only and are not intended to be used for carpet sizes, appliance space or items of furniture. Apartment areas are provided as gross internal areas under the RICS measuring practice. Due to the unique design of these homes, measurements and areas may vary within a tolerance of 5%. Kitchen layouts are indicative only and are subject to change. All garden exterior dimensions and areas are approximate and may vary within a tolerance of 10% subject to detailed design.

1 BEDROOM APARTMENT

BLOCK FOUR

Plot Number
D4-2-05



LOCATOR

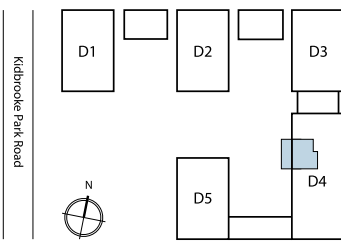

ROOM DIMENSIONS

Living/Dining/Kitchen	5.74m x 4.39m	18'10" x 14'5"
Bedroom	3.60m x 3.29m	11'10" x 10'10"
Terrace	7.05m x 2.62m	23'2" x 8'7"
Total internal area:	50.0 sq m	538 sq ft

C Structural Column WM Provision for washing machine HIU Heat interface unit ◀ ▶ Measurement points

TYPE: 13

These layouts are not to scale and provide approximate measurements and are indicative only. Dimensions, which are taken from the indicated points of measurements are for guidance only and are not intended to be used for carpet sizes, appliance space or items of furniture. Apartment areas are provided as gross internal areas under the RICS measuring practice. Due to the unique design of these homes, measurements and areas may vary within a tolerance of 5%. All garden exterior dimensions and areas are approximate and may vary within a tolerance of 10% subject to detailed design.

1 BEDROOM APARTMENT

BLOCK FOUR

Plot Number
D4-2-04



LOCATOR

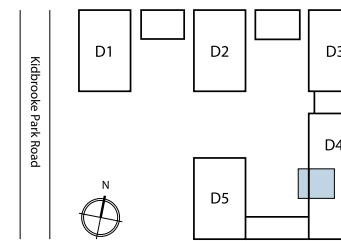

ROOM DIMENSIONS

Living/Dining/Kitchen	6.46m x 4.38m	21'3" x 14'5"
Bedroom	4.29m x 3.41m	14'1" x 11'2"
Terrace	7.57m x 2.57m	24'10" x 8'6"
Total internal area:	52.0 sq m	560 sq ft

C Structural Column WM Provision for washing machine HIU Heat interface unit ◀ ▶ Measurement points

TYPE: 15A

These layouts are not to scale and provide approximate measurements and are indicative only. Dimensions, which are taken from the indicated points of measurements are for guidance only and are not intended to be used for carpet sizes, appliance space or items of furniture. Apartment areas are provided as gross internal areas under the RICS measuring practice. Due to the unique design of these homes, measurements and areas may vary within a tolerance of 5%. All garden exterior dimensions and areas are approximate and may vary within a tolerance of 10% subject to detailed design.

1 BEDROOM APARTMENT

BLOCK FOUR

Plot Number
D4-2-03



LOCATOR

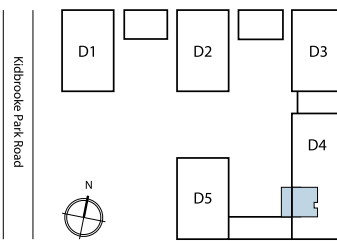

ROOM DIMENSIONS

Living/Dining/Kitchen	6.43m x 4.17m	21'1" x 13'8"
Bedroom	3.80m x 3.39m	12'6" x 11'2"
Terrace	7.98m x 2.76m	26'2" x 9'1"
Total internal area:	52.0 sq m	560 sq ft

C Structural Column WM Provision for washing machine HIU Heat interface unit ◀ ▶ Measurement points

TYPE: 20A

These layouts are not to scale and provide approximate measurements and are indicative only. Dimensions, which are taken from the indicated points of measurements are for guidance only and are not intended to be used for carpet sizes, appliance space or items of furniture. Apartment areas are provided as gross internal areas under the RICS measuring practice. Due to the unique design of these homes, measurements and areas may vary within a tolerance of 5%. All garden exterior dimensions and areas are approximate and may vary within a tolerance of 10% subject to detailed design.

2 BEDROOM APARTMENTS

BLOCKS ONE, TWO, THREE & FIVE

Plot Numbers

D1-3-01*	D1-7-01*	D2-4-01*	D2-8-01*	D3-2-06 †	D3-6-07 †	D3-10-06 †	D3-14-06 †	D5-4-01*	D5-9-01*
D1-3-02	D1-7-02	D2-4-02	D2-8-02	D3-3-06*	D3-7-06*	D3-11-05*	D3-15-05*	D5-4-02	D5-9-02
D1-4-01*	D1-9-01*	D2-5-01*	D2-10-01*	D3-3-07 †	D3-7-07 †	D3-11-06 †	D3-15-06 †	D5-6-01*	
D1-4-02	D1-9-02	D2-5-02	D2-10-02	D3-5-06*	D3-9-05*	D3-13-05*	D5-1U-02	D5-6-02	
D1-6-01*	D1-10-01*	D2-7-01*	D2-11-01*	D3-5-07 †	D3-9-06 †	D3-13-06 †	D5-3-01*	D5-7-01*	
D1-6-02	D1-10-02	D2-7-02	D2-11-02	D3-6-06*	D3-10-05*	D3-14-05*	D5-3-02	D5-7-02	



LOCATOR

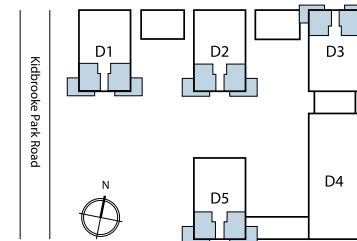

ROOM DIMENSIONS

Living/Dining/Kitchen	5.26m x 4.64m	17'3" x 15'3"
Bedroom 1	3.60m x 3.50m	11'10" x 11'6"
Bedroom 2	3.58m x 3.40m	11'9" x 11'2"
Balcony	2.90m x 1.50m	9'6" x 4'11"
Total internal area:	71.0 sq m	764 sq ft

C Structural Column WM Provision for washing machine HIU Heat interface unit ◀ ▶ Measurement points

TYPE: 1A

* Plot is handed
† Plot is rotated

These layouts are not to scale and provide approximate measurements and are indicative only. Dimensions, which are taken from the indicated points of measurements are for guidance only and are not intended to be used for carpet sizes, appliance space or items of furniture. Apartment areas are provided as gross internal areas under the RICS measuring practice. Due to the unique design of these homes, measurements and areas may vary within a tolerance of 5%. Kitchen layouts are indicative only and are subject to change. All garden exterior dimensions and areas are approximate and may vary within a tolerance of 10% subject to detailed design.

2 BEDROOM APARTMENTS

BLOCKS ONE, TWO, THREE & FIVE

2 BEDROOM APARTMENTS

BLOCKS ONE, TWO, THREE & FIVE

Plot Numbers							
D1-2-02	D1-8-01*	D2-3-02	D2-9-01*	D2-12-02	D3-8-05*	D3-12-06 †	D5-5-02
D1-5-01*	D1-8-02	D2-6-01*	D2-9-02	D3-4-06*	D3-8-06 †	D5-2-02	D5-8-01*
D1-5-02	D2-3-01*	D2-6-02	D2-12-01*	D3-4-07 †	D3-12-05*	D5-5-01*	D5-8-02

Plot Numbers								
D1-4-04	D1-7-04	D2-5-04	D2-8-04	D3-10-02 †	D3-13-02 †	D3-15-02 †	D5-6-05*	D5-9-05*
D1-4-05*	D1-7-05*	D2-5-05*	D2-8-05*	D3-10-03*	D3-13-03*	D3-15-03*	D5-7-04	
D1-6-04	D2-4-04	D2-7-04	D3-9-02 †	D3-11-02 †	D3-14-02 †	D5-4-05*	D5-7-05*	
D1-6-05*	D2-4-05*	D2-7-05*	D3-9-03*	D3-11-03*	D3-14-03*	D5-6-04	D5-9-04	



LOCATOR

ROOM DIMENSIONS

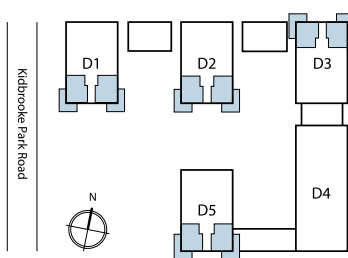

Living/Dining/Kitchen	5.40m x 4.64m	17'9" x 15'3"
Bedroom 1	3.60m x 3.50m	11'10" x 11'6"
Bedroom 2	3.58m x 3.40m	11'9" x 11'2"
Balcony	4.50m x 1.50m	14'9" x 4'11"
Total internal area:	71.0 sq m	764 sq ft

LOCATOR

ROOM DIMENSIONS

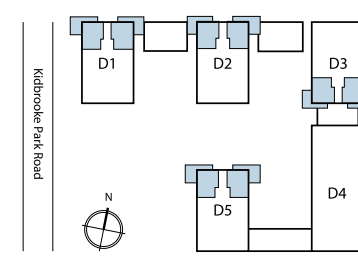

Living/Dining/Kitchen	5.59m x 4.10m	18'4" x 13'6"
Bedroom 1	3.65m x 3.44m	12'0" x 11'3"
Bedroom 2	4.18m x 2.65m	13'9" x 8'8"
Balcony	5.13m x 2.91m	16'10" x 9'7"
Total internal area:	62.0 sq m	667 sq ft

* Plot is handed
† Plot is rotated

C Structural Column WM Provision for washing machine HIU Heat interface unit ◀▶ Measurement points

TYPE: 1B

* Plot is handed
† Plot is rotated

C Structural Column WM Provision for washing machine HIU Heat interface unit ◀▶ Measurement points

TYPE: 3A

These layouts are not to scale and provide approximate measurements and are indicative only. Dimensions, which are taken from the indicated points of measurements are for guidance only and are not intended to be used for carpet sizes, appliance space or items of furniture. Apartment areas are provided as gross internal areas under the RICS measuring practice. Due to the unique design of these homes, measurements and areas may vary within a tolerance of 5%. Kitchen layouts are indicative only and are subject to change. All garden exterior dimensions and areas are approximate and may vary within a tolerance of 10% subject to detailed design.

These layouts are not to scale and provide approximate measurements and are indicative only. Dimensions, which are taken from the indicated points of measurements are for guidance only and are not intended to be used for carpet sizes, appliance space or items of furniture. Apartment areas are provided as gross internal areas under the RICS measuring practice. Due to the unique design of these homes, measurements and areas may vary within a tolerance of 5%. Kitchen layouts are indicative only and are subject to change. All garden exterior dimensions and areas are approximate and may vary within a tolerance of 10% subject to detailed design.

2 BEDROOM APARTMENTS BLOCKS ONE, TWO, THREE & FIVE

Plot Numbers					
D1-5-04	D2-6-04	D2-9-04	D3-12-02 †	D5-5-04	D5-8-04
D1-5-05*	D2-6-05*	D2-9-05*	D3-12-03*	D5-5-05*	D5-8-05*



LOCATOR

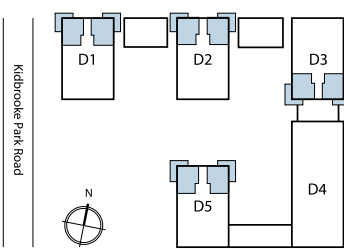

ROOM DIMENSIONS

Living/Dining/Kitchen	5.59m x 4.23m	18'4" x 13'11"
Bedroom 1	3.65m x 3.44m	12'0" x 11'4"
Bedroom 2	4.18m x 2.65m	13'9" x 8'8"
Balcony	4.51m x 1.50m	14'10" x 4'11"
Total internal area:	62.0 sq m	667 sq ft

* Plot is handed
† Plot is rotated

C Structural Column WM Provision for washing machine HIU Heat interface unit ◀▶ Measurement points

TYPE: 3C

These layouts are not to scale and provide approximate measurements and are indicative only. Dimensions, which are taken from the indicated points of measurements are for guidance only and are not intended to be used for carpet sizes, appliance space or items of furniture. Apartment areas are provided as gross internal areas under the RICS measuring practice. Due to the unique design of these homes, measurements and areas may vary within a tolerance of 5%. Kitchen layouts are indicative only and are subject to change. All garden exterior dimensions and areas are approximate and may vary within a tolerance of 10% subject to detailed design.

2 BEDROOM APARTMENTS BLOCK FOUR

Plot Numbers			
D4-1U-01	D4-3-01	D4-5-01	D4-7-01
D4-2-01	D4-4-01	D4-6-01	D4-8-01



LOCATOR

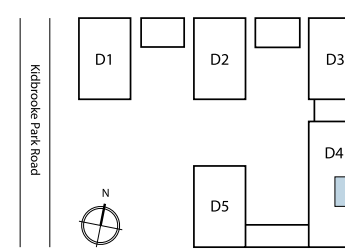

ROOM DIMENSIONS

Living/Dining/Kitchen	6.62m x 4.11m	21'9" x 13'6"
Bedroom 1	4.44m x 2.75m	14'7" x 9'0"
Bedroom 2	3.42m x 3.19m	11'3" x 10'6"
Balcony	3.39m x 1.96m	11'1" x 6'5"
Total internal area:	71.0 sq m	764 sq ft

C Structural Column WM Provision for washing machine HIU Heat interface unit ◀▶ Measurement points

TYPE: 18

These layouts are not to scale and provide approximate measurements and are indicative only. Dimensions, which are taken from the indicated points of measurements are for guidance only and are not intended to be used for carpet sizes, appliance space or items of furniture. Apartment areas are provided as gross internal areas under the RICS measuring practice. Due to the unique design of these homes, measurements and areas may vary within a tolerance of 5%. Kitchen layouts are indicative only and are subject to change. All garden exterior dimensions and areas are approximate and may vary within a tolerance of 10% subject to detailed design.

2 BEDROOM APARTMENT BLOCK TWO

Plot Number
D2-2-01



LOCATOR

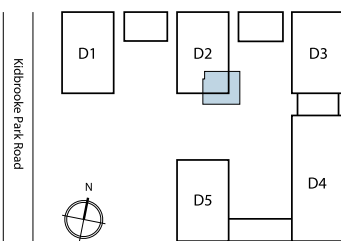

ROOM DIMENSIONS

Living/Dining/Kitchen	5.26m x 4.58m	17'3" x 15'1"
Bedroom 1	3.65m x 3.50m	12'0" x 11'6"
Bedroom 2	3.57m x 3.40m	11'9" x 11'2"
Terrace	10.84m x 2.37m	35'7" x 7'9"
Total internal area:	71.0 sq m	764 sq ft

C Structural Column WM Provision for washing machine HIU Heat interface unit ◀ ▶ Measurement points

TYPE: 1C

These layouts are not to scale and provide approximate measurements and are indicative only. Dimensions, which are taken from the indicated points of measurements are for guidance only and are not intended to be used for carpet sizes, appliance space or items of furniture. Apartment areas are provided as gross internal areas under the RICS measuring practice. Due to the unique design of these homes, measurements and areas may vary within a tolerance of 5%. All garden exterior dimensions and areas are approximate and may vary within a tolerance of 10% subject to detailed design.

2 BEDROOM APARTMENTS BLOCK THREE

Plot Numbers
D3-8-02 D3-8-03*



LOCATOR

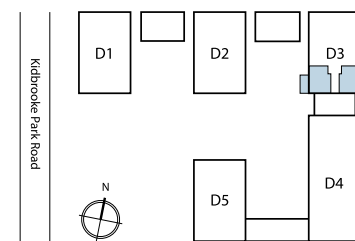

ROOM DIMENSIONS

Living/Dining/Kitchen	5.64m x 4.23m	18'6" x 13'11"
Bedroom 1	3.65m x 3.45m	12'0" x 11'4"
Bedroom 2	4.05m x 2.65m	13'4" x 8'8"
Balcony	3.37m x 1.50m	11'1" x 4'11"
Total internal area:	62.0 sq m	667 sq ft

* Plot is handed

C Structural Column WM Provision for washing machine HIU Heat interface unit ◀ ▶ Measurement points

TYPE: 3B

These layouts are not to scale and provide approximate measurements and are indicative only. Dimensions, which are taken from the indicated points of measurements are for guidance only and are not intended to be used for carpet sizes, appliance space or items of furniture. Apartment areas are provided as gross internal areas under the RICS measuring practice. Due to the unique design of these homes, measurements and areas may vary within a tolerance of 5%. All garden exterior dimensions and areas are approximate and may vary within a tolerance of 10% subject to detailed design.

2 BEDROOM APARTMENT BLOCK TWO

Plot Number
D2-2-04



2 BEDROOM APARTMENT BLOCK ONE

Plot Number
D1-2-05



LOCATOR

ROOM DIMENSIONS

Living/Dining/Kitchen	5.59m x 4.10m	18'4" x 13'6"
Bedroom 1	3.65m x 3.44m	12'0" x 11'4"
Bedroom 2	4.18m x 2.65m	13'9" x 8'8"
Terrace	8.61m x 2.47m	28'2" x 8'1"
Total internal area:	62.0 sq m	667 sq ft

LOCATOR

ROOM DIMENSIONS

Living/Dining/Kitchen	8.39m x 4.28m	27'6" x 14'1"
Bedroom 1	5.04m x 2.75m	16'7" x 9'0"
Bedroom 2	3.20m x 2.95m	10'6" x 9'8"
Terrace	11.10m x 2.47m	36'3" x 8'1"
Total internal area:	80.0 sq m	861 sq ft

C Structural Column WM Provision for washing machine HIU Heat interface unit ◀ ▶ Measurement points

TYPE: 3D

C Structural Column WM Provision for washing machine HIU Heat interface unit ◀ ▶ Measurement points

TYPE: 4A

These layouts are not to scale and provide approximate measurements and are indicative only. Dimensions, which are taken from the indicated points of measurements are for guidance only and are not intended to be used for carpet sizes, appliance space or items of furniture. Apartment areas are provided as gross internal areas under the RICS measuring practice. Due to the unique design of these homes, measurements and areas may vary within a tolerance of 5%. Kitchen layouts are indicative only and are subject to change. All garden exterior dimensions and areas are approximate and may vary within a tolerance of 10% subject to detailed design.

These layouts are not to scale and provide approximate measurements and are indicative only. Dimensions, which are taken from the indicated points of measurements are for guidance only and are not intended to be used for carpet sizes, appliance space or items of furniture. Apartment areas are provided as gross internal areas under the RICS measuring practice. Due to the unique design of these homes, measurements and areas may vary within a tolerance of 5%. Kitchen layouts are indicative only and are subject to change. All garden exterior dimensions and areas are approximate and may vary within a tolerance of 10% subject to detailed design.

2 BEDROOM APARTMENT BLOCK TWO

Plot Number
D2-2-03



2 BEDROOM APARTMENT BLOCK FIVE

Plot Number
D5-2-05



LOCATOR

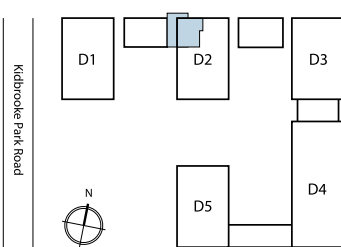

ROOM DIMENSIONS

Living/Dining/Kitchen	8.34m x 4.28m	27'4" x 14'1"
Bedroom 1	5.04m x 2.75m	16'7" x 9'0"
Bedroom 2	3.20m x 2.95m	10'6" x 9'8"
Terrace	11.11m x 2.59m	36'5" x 8'6"
Total internal area:	80.0 sq m	861 sq ft

LOCATOR

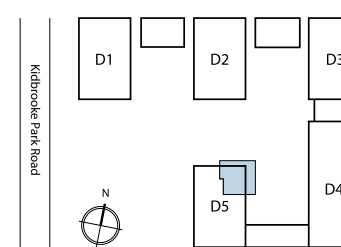

ROOM DIMENSIONS

Living/Dining/Kitchen	8.39m x 4.28m	27'6" x 14'1"
Bedroom 1	5.04m x 2.75m	16'7" x 9'0"
Bedroom 2	3.20m x 2.95m	10'6" x 9'8"
Terrace	11.93m x 1.85m	39'2" x 6'1"
Total internal area:	80.0 sq m	861 sq ft

C Structural Column WM Provision for washing machine HIU Heat interface unit ◀ ▶ Measurement points

TYPE: 4B

C Structural Column WM Provision for washing machine HIU Heat interface unit ▶ ◀ Measurement points

TYPE: 4C

These layouts are not to scale and provide approximate measurements and are indicative only. Dimensions, which are taken from the indicated points of measurements are for guidance only and are not intended to be used for carpet sizes, appliance space or items of furniture. Apartment areas are provided as gross internal areas under the RICS measuring practice. Due to the unique design of these homes, measurements and areas may vary within a tolerance of 5%. All garden exterior dimensions and areas are approximate and may vary within a tolerance of 10% subject to detailed design.

These layouts are not to scale and provide approximate measurements and are indicative only. Dimensions, which are taken from the indicated points of measurements are for guidance only and are not intended to be used for carpet sizes, appliance space or items of furniture. Apartment areas are provided as gross internal areas under the RICS measuring practice. Due to the unique design of these homes, measurements and areas may vary within a tolerance of 5%. All garden exterior dimensions and areas are approximate and may vary within a tolerance of 10% subject to detailed design.

2 BEDROOM APARTMENT BLOCK THREE

Plot Number
D3-2-04



LOCATOR

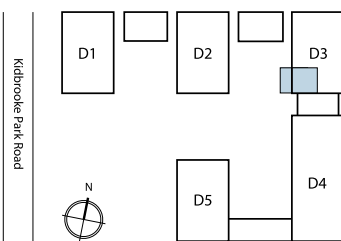

ROOM DIMENSIONS

Living/Dining/Kitchen	7.49m x 4.00m	24'7" x 13'2"
Bedroom 1	4.91m x 2.80m	16'1" x 9'2"
Bedroom 2	3.74m x 3.12m	12'3" x 10'3"
Terrace	9.46m x 2.01m	31'1" x 6'7"
Total internal area:	75.0 sq m	807 sq ft

C Structural Column WM Provision for washing machine HIU Heat interface unit ◀▶ Measurement points

TYPE: 6

These layouts are not to scale and provide approximate measurements and are indicative only. Dimensions, which are taken from the indicated points of measurements are for guidance only and are not intended to be used for carpet sizes, appliance space or items of furniture. Apartment areas are provided as gross internal areas under the RICS measuring practice. Due to the unique design of these homes, measurements and areas may vary within a tolerance of 5%. Kitchen layouts are indicative only and are subject to change. All garden exterior dimensions and areas are approximate and may vary within a tolerance of 10% subject to detailed design.

2 BEDROOM APARTMENT BLOCK FIVE

Plot Number
D5-G-01



LOCATOR

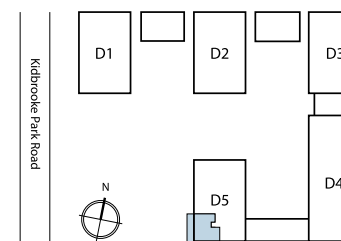

ROOM DIMENSIONS

Living/Dining/Kitchen	8.18m x 3.60m	26'10" x 11'10"
Bedroom 1	4.31m x 2.75m	14'2" x 9'0"
Bedroom 2	3.15m x 2.55m	10'4" x 8'4"
Terrace	10.50m x 2.25m	34'6" x 7'5"
Total internal area:	64.0 sq m	689 sq ft

C Structural Column WM Provision for washing machine HIU Heat interface unit ◀▶ Measurement points

TYPE: 9

These layouts are not to scale and provide approximate measurements and are indicative only. Dimensions, which are taken from the indicated points of measurements are for guidance only and are not intended to be used for carpet sizes, appliance space or items of furniture. Apartment areas are provided as gross internal areas under the RICS measuring practice. Due to the unique design of these homes, measurements and areas may vary within a tolerance of 5%. Kitchen layouts are indicative only and are subject to change. All garden exterior dimensions and areas are approximate and may vary within a tolerance of 10% subject to detailed design.

2 BEDROOM APARTMENTS BLOCK FIVE

Plot Numbers
D5-1L-01 D5-1U-01



LOCATOR

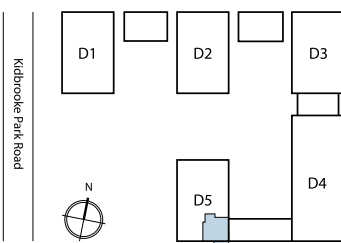

ROOM DIMENSIONS

Living/Dining/Kitchen	6.23m x 4.10m	20'5" x 13'5"
Bedroom 1	5.60m x 2.75m	18'4" x 9'0"
Bedroom 2	3.20m x 2.93m	10'6" x 9'7"
Balcony	4.83m x 1.51m	15'10" x 4'11"
Total internal area:	75.0 sq m	807 sq ft

C Structural Column WM Provision for washing machine HIU Heat interface unit ◀ ▶ Measurement points

TYPE: 10

These layouts are not to scale and provide approximate measurements and are indicative only. Dimensions, which are taken from the indicated points of measurements are for guidance only and are not intended to be used for carpet sizes, appliance space or items of furniture. Apartment areas are provided as gross internal areas under the RICS measuring practice. Due to the unique design of these homes, measurements and areas may vary within a tolerance of 5%. Kitchen layouts are indicative only and are subject to change. All garden exterior dimensions and areas are approximate and may vary within a tolerance of 10% subject to detailed design.

2 BEDROOM APARTMENT BLOCK FIVE

Plot Number
D5-1U-03



LOCATOR

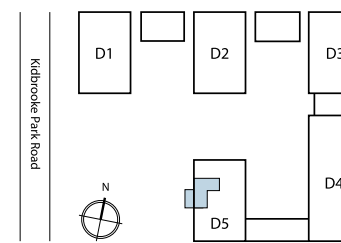

ROOM DIMENSIONS

Living/Dining/Kitchen	6.70m x 3.66m	22'0" x 12'0"
Bedroom 1	5.04m x 2.75m	16'7" x 9'0"
Bedroom 2	3.89m x 2.75m	12'9" x 9'0"
Balcony	3.37m x 1.50m	11'1" x 4'11"
Total internal area:	72.0 sq m	775 sq ft

C Structural Column WM Provision for washing machine HIU Heat interface unit ◀ ▶ Measurement points

TYPE: 11

These layouts are not to scale and provide approximate measurements and are indicative only. Dimensions, which are taken from the indicated points of measurements are for guidance only and are not intended to be used for carpet sizes, appliance space or items of furniture. Apartment areas are provided as gross internal areas under the RICS measuring practice. Due to the unique design of these homes, measurements and areas may vary within a tolerance of 5%. Kitchen layouts are indicative only and are subject to change. All garden exterior dimensions and areas are approximate and may vary within a tolerance of 10% subject to detailed design.

2 BEDROOM APARTMENTS BLOCK FOUR

Plot Numbers
D4-5-05 D4-6-05 D4-7-05 D4-8-05



LOCATOR

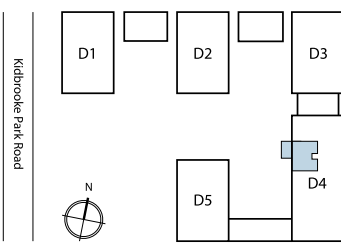

ROOM DIMENSIONS

Living/Dining/Kitchen	6.46m x 3.92m	21'3" x 12'11"
Bedroom 1	4.29m x 3.22m	14'1" x 10'7"
Bedroom 2	4.29m x 2.55m	14'1" x 8'4"
Balcony	3.34m x 1.55m	11'0" x 5'1"
Total internal area:	64.0 sq m	689 sq ft

C Structural Column WM Provision for washing machine HIU Heat interface unit ◀ ▶ Measurement points

TYPE: 19

These layouts are not to scale and provide approximate measurements and are indicative only. Dimensions, which are taken from the indicated points of measurements are for guidance only and are not intended to be used for carpet sizes, appliance space or items of furniture. Apartment areas are provided as gross internal areas under the RICS measuring practice. Due to the unique design of these homes, measurements and areas may vary within a tolerance of 5%. Kitchen layouts are indicative only and are subject to change. All garden exterior dimensions and areas are approximate and may vary within a tolerance of 10% subject to detailed design.

2 BEDROOM APARTMENTS PODIUM APARTMENTS

Plot Numbers
DP-2-01 DP-2-02 DP-2-03 DP-2-04



LOCATOR

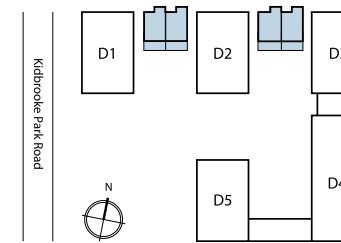

ROOM DIMENSIONS

Living/Dining/Kitchen	7.24m x 3.35m	23'9" x 11'0"
Bedroom 1	3.33m x 3.28m	10'11" x 10'9"
Bedroom 2	3.18m x 2.78m	10'5" x 9'2"
Terrace	6.74m x 1.50m	22'1" x 4'11"
Total internal area:	67.0 sq m	721 sq ft

C Structural Column WM Provision for washing machine HIU Heat interface unit ▶ Measurement points

TYPE: 21

These layouts are not to scale and provide approximate measurements and are indicative only. Dimensions, which are taken from the indicated points of measurements are for guidance only and are not intended to be used for carpet sizes, appliance space or items of furniture. Apartment areas are provided as gross internal areas under the RICS measuring practice. Due to the unique design of these homes, measurements and areas may vary within a tolerance of 5%. Kitchen layouts are indicative only and are subject to change. All garden exterior dimensions and areas are approximate and may vary within a tolerance of 10% subject to detailed design.

2 BEDROOM APARTMENTS BLOCK ONE & TWO

Plot Numbers
D1-11-01 D2-13-01



LOCATOR

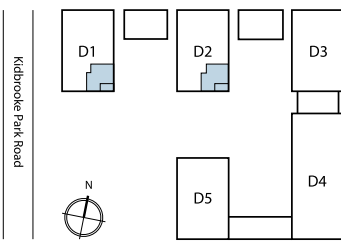

ROOM DIMENSIONS

Living/Dining/Kitchen	5.61m x 4.06m	18'5" x 13'4"
Bedroom 1	3.61m x 3.20m	11'10" x 10'6"
Bedroom 2	4.01m x 2.50m	13'2" x 8'2"
Terrace	3.51m x 1.50m	11'6" x 4'11"
Total internal area:	64.0 sq m	689 sq ft

C Structural Column WM Provision for washing machine HIU Heat interface unit ◀ ▶ Measurement points

TYPE: 23

These layouts are not to scale and provide approximate measurements and are indicative only. Dimensions, which are taken from the indicated points of measurements are for guidance only and are not intended to be used for carpet sizes, appliance space or items of furniture. Apartment areas are provided as gross internal areas under the RICS measuring practice. Due to the unique design of these homes, measurements and areas may vary within a tolerance of 5%. All garden exterior dimensions and areas are approximate and may vary within a tolerance of 10% subject to detailed design.

3 BEDROOM APARTMENTS BLOCK ONE

Plot Number
D1-8-04



LOCATOR

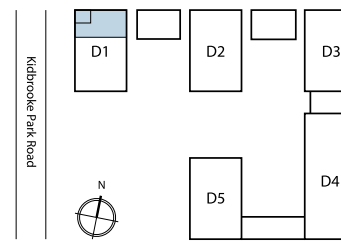

ROOM DIMENSIONS

Living/Dining/Kitchen	9.11m x 4.01m	29'10" x 13'2"
Bedroom 1	4.16m x 4.07m	13'8" x 13'4"
Bedroom 2	3.87m x 3.28m	12'9" x 10'9"
Bedroom 3	3.54m x 3.15m	11'8" x 10'4"
Terrace	3.76m x 3.76m	12'4" x 12'4"
Total internal area:	115.0 sq m	1238 sq ft

* Plot is handed C Structural Column WM Provision for washing machine HIU Heat interface unit ▶ Measurement points

TYPE: 22

These layouts are not to scale and provide approximate measurements and are indicative only. Dimensions, which are taken from the indicated points of measurements are for guidance only and are not intended to be used for carpet sizes, appliance space or items of furniture. Apartment areas are provided as gross internal areas under the RICS measuring practice. Due to the unique design of these homes, measurements and areas may vary within a tolerance of 5%. All garden exterior dimensions and areas are approximate and may vary within a tolerance of 10% subject to detailed design.

3 BEDROOM APARTMENTS BLOCK THREE

Plot Numbers
D3-3-03 D3-4-03 D3-5-03 D3-6-03 D3-7-03



LOCATOR

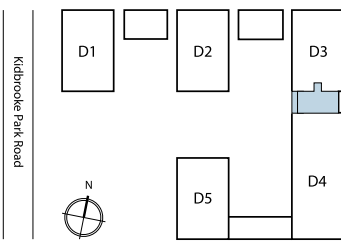

ROOM DIMENSIONS

Living/Dining/Kitchen	7.43m x 3.98m	24'5" x 13'1"
Bedroom 1	3.48m x 3.46m	11'5" x 11'4"
Bedroom 2	3.68m x 3.15m	12'1" x 10'4"
Bedroom 3	4.68m x 2.65m	15'4" x 8'8"
Balcony	6.31m x 1.54m	20'8" x 5'1"
Total internal area:	99.0 sq m	1066 sq ft

C Structural Column WM Provision for washing machine HIU Heat interface unit ◀ ▶ Measurement points

TYPE: 7B

These layouts are not to scale and provide approximate measurements and are indicative only. Dimensions, which are taken from the indicated points of measurements are for guidance only and are not intended to be used for carpet sizes, appliance space or items of furniture. Apartment areas are provided as gross internal areas under the RICS measuring practice. Due to the unique design of these homes, measurements and areas may vary within a tolerance of 5%. Kitchen layouts are indicative only and are subject to change. All garden exterior dimensions and areas are approximate and may vary within a tolerance of 10% subject to detailed design.

3 BEDROOM APARTMENTS BLOCK FOUR

Plot Numbers
D4-3-06 D4-4-06 D4-5-06 D4-6-06 D4-7-06 D4-8-06



LOCATOR

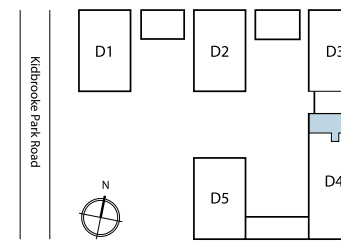

ROOM DIMENSIONS

Living/Dining/Kitchen	9.10m x 3.24m	29'10" x 10'8"
Bedroom 1	3.60m x 3.50m	11'10" x 11'6"
Bedroom 2	4.56m x 2.55m	15'0" x 8'4"
Bedroom 3	3.60m x 2.87m	11'10" x 9'5"
Balcony	5.97m x 1.79m	19'7" x 5'11"
Total internal area:	96.0 sq m	1033 sq ft

C Structural Column WM Provision for washing machine HIU Heat interface unit ▶ ◀ Measurement points

TYPE: 14B

These layouts are not to scale and provide approximate measurements and are indicative only. Dimensions, which are taken from the indicated points of measurements are for guidance only and are not intended to be used for carpet sizes, appliance space or items of furniture. Apartment areas are provided as gross internal areas under the RICS measuring practice. Due to the unique design of these homes, measurements and areas may vary within a tolerance of 5%. Kitchen layouts are indicative only and are subject to change. All garden exterior dimensions and areas are approximate and may vary within a tolerance of 10% subject to detailed design.

3 BEDROOM APARTMENTS BLOCK FOUR

Plot Numbers
D4-2-02** D4-3-02 D4-4-02** D4-5-02** D4-6-02 D4-7-02** D4-8-02**



LOCATOR

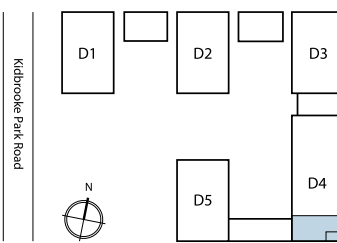

ROOM DIMENSIONS

Living/Dining/Kitchen	7.12m x 5.69m	23'4" x 18'8"
Bedroom 1	4.34m x 3.56m	14'3" x 11'8"
Bedroom 2	3.78m x 2.92m	12'5" x 9'7"
Bedroom 3	4.34m x 2.65m	14'3" x 8'8"
Balcony	5.42m x 1.66m	17'10" x 5'5"
Total internal area:	106.0 sq m	1141 sq ft

**Plots have wrap around windows in living area. Please speak to Sales Consultant for more information.

C Structural Column WM Provision for washing machine HIU Heat interface unit ◀▶ Measurement points

TYPE: 17

These layouts are not to scale and provide approximate measurements and are indicative only. Dimensions, which are taken from the indicated points of measurements are for guidance only and are not intended to be used for carpet sizes, appliance space or items of furniture. Apartment areas are provided as gross internal areas under the RICS measuring practice. Due to the unique design of these homes, measurements and areas may vary within a tolerance of 5%. All garden exterior dimensions and areas are approximate and may vary within a tolerance of 10% subject to detailed design.

3 BEDROOM APARTMENT BLOCK ONE

Plot Number
D1-2-01



LOCATOR

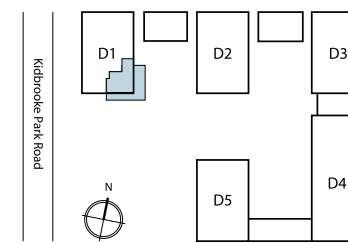

ROOM DIMENSIONS

Living/Dining/Kitchen	5.69m x 4.49m	18'8" x 14'9"
Bedroom 1	3.68m x 2.87m	12'1" x 9'5"
Bedroom 2	4.49m x 2.65m	14'9" x 8'8"
Bedroom 3	4.50m x 2.55m	14'9" x 8'4"
Terrace	10.53m x 2.00m	34'7" x 6'7"
Total internal area:	92.0 sq m	990 sq ft

C Structural Column WM Provision for washing machine HIU Heat interface unit ▶◀ Measurement points

TYPE: 5A

These layouts are not to scale and provide approximate measurements and are indicative only. Dimensions, which are taken from the indicated points of measurements are for guidance only and are not intended to be used for carpet sizes, appliance space or items of furniture. Apartment areas are provided as gross internal areas under the RICS measuring practice. Due to the unique design of these homes, measurements and areas may vary within a tolerance of 5%. All garden exterior dimensions and areas are approximate and may vary within a tolerance of 10% subject to detailed design.

3 BEDROOM APARTMENT BLOCK TWO

Plot Number
D2-2-02



LOCATOR

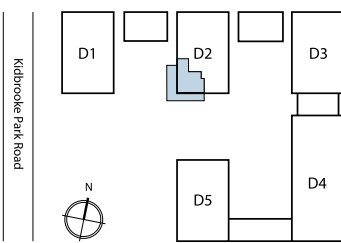

ROOM DIMENSIONS

Living/Dining/Kitchen	5.69m x 4.49m	18'8" x 14'9"
Bedroom 1	3.68m x 2.87m	12'1" x 9'5"
Bedroom 2	4.49m x 2.65m	14'9" x 8'8"
Bedroom 3	4.50m x 2.55m	14'9" x 8'4"
Terrace	10.53m x 2.00m	34'7" x 6'7"
Total internal area:	92.0 sq m	990 sq ft

C Structural Column WM Provision for washing machine HIU Heat interface unit ◀ ▶ Measurement points

TYPE: 5B

These layouts are not to scale and provide approximate measurements and are indicative only. Dimensions, which are taken from the indicated points of measurements are for guidance only and are not intended to be used for carpet sizes, appliance space or items of furniture. Apartment areas are provided as gross internal areas under the RICS measuring practice. Due to the unique design of these homes, measurements and areas may vary within a tolerance of 5%. All garden exterior dimensions and areas are approximate and may vary within a tolerance of 10% subject to detailed design.

3 BEDROOM APARTMENT BLOCK THREE

Plot Number
D3-2-05



LOCATOR

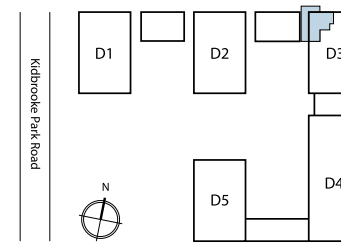

ROOM DIMENSIONS

Living/Dining/Kitchen	5.69m x 4.49m	18'8" x 14'9"
Bedroom 1	3.68m x 2.87m	12'1" x 9'5"
Bedroom 2	4.49m x 2.65m	14'9" x 8'8"
Bedroom 3	4.50m x 2.55m	14'9" x 8'4"
Terrace	15.40m x 2.59m	50'7" x 8'6"
Total internal area:	92.0 sq m	990 sq ft

C Structural Column WM Provision for washing machine HIU Heat interface unit ◀ ▶ Measurement points

TYPE: 5C

These layouts are not to scale and provide approximate measurements and are indicative only. Dimensions, which are taken from the indicated points of measurements are for guidance only and are not intended to be used for carpet sizes, appliance space or items of furniture. Apartment areas are provided as gross internal areas under the RICS measuring practice. Due to the unique design of these homes, measurements and areas may vary within a tolerance of 5%. All garden exterior dimensions and areas are approximate and may vary within a tolerance of 10% subject to detailed design.

3 BEDROOM APARTMENT BLOCK FIVE

Plot Number
D5-1L-02



LOCATOR

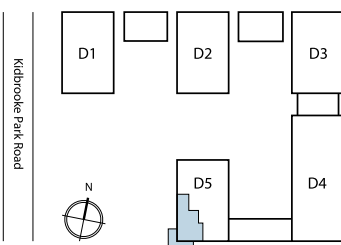

ROOM DIMENSIONS

Living/Dining/Kitchen	5.72m x 4.49m	18'9" x 14'9"
Bedroom 1	3.68m x 2.87m	12'1" x 9'5"
Bedroom 2	4.52m x 2.65m	14'10" x 8'8"
Bedroom 3	4.50m x 2.52m	14'9" x 8'3"
Balcony	5.12m x 0.86m	16'10" x 2'10"
Total internal area:	92.0 sq m	990 sq ft

C Structural Column WM Provision for washing machine HIU Heat interface unit ◀ ▶ Measurement points

TYPE: 5D

These layouts are not to scale and provide approximate measurements and are indicative only. Dimensions, which are taken from the indicated points of measurements are for guidance only and are not intended to be used for carpet sizes, appliance space or items of furniture. Apartment areas are provided as gross internal areas under the RICS measuring practice. Due to the unique design of these homes, measurements and areas may vary within a tolerance of 5%. Kitchen layouts are indicative only and are subject to change. All garden exterior dimensions and areas are approximate and may vary within a tolerance of 10% subject to detailed design.

3 BEDROOM APARTMENT BLOCK FIVE

Plot Number
D5-2-01



LOCATOR

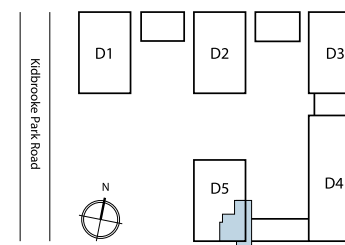

ROOM DIMENSIONS

Living/Dining/Kitchen	5.69m x 4.49m	18'8" x 14'9"
Bedroom 1	3.68m x 2.87m	12'1" x 9'5"
Bedroom 2	4.49m x 2.65m	14'9" x 8'8"
Bedroom 3	4.45m x 2.55m	14'7" x 8'4"
Terrace	15.03m x 1.43m	49'4" x 4'8"
Total internal area:	92.0 sq m	990 sq ft

C Structural Column WM Provision for washing machine HIU Heat interface unit ▶ ◀ Measurement points

TYPE: 5E

These layouts are not to scale and provide approximate measurements and are indicative only. Dimensions, which are taken from the indicated points of measurements are for guidance only and are not intended to be used for carpet sizes, appliance space or items of furniture. Apartment areas are provided as gross internal areas under the RICS measuring practice. Due to the unique design of these homes, measurements and areas may vary within a tolerance of 5%. Kitchen layouts are indicative only and are subject to change. All garden exterior dimensions and areas are approximate and may vary within a tolerance of 10% subject to detailed design.

3 BEDROOM APARTMENT BLOCK THREE

Plot Number
D3-2-03



LOCATOR

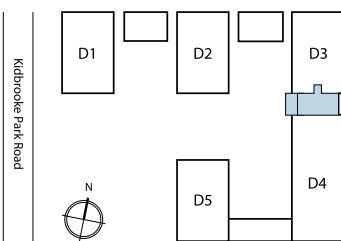

ROOM DIMENSIONS

Living/Dining/Kitchen	7.40m x 3.98m	24'4" x 13'1"
Bedroom 1	3.48m x 3.46m	11'5" x 11'4"
Bedroom 2	3.68m x 3.15m	12'1" x 10'4"
Bedroom 3	4.67m x 2.65m	15'4" x 8'8"
Terrace	6.35m x 4.35m	21'5" x 14'3"
Total internal area:	99.0 sq m	1066 sq ft

C Structural Column WM Provision for washing machine HIU Heat interface unit ◀▶ Measurement points

TYPE: 7A

These layouts are not to scale and provide approximate measurements and are indicative only. Dimensions, which are taken from the indicated points of measurements are for guidance only and are not intended to be used for carpet sizes, appliance space or items of furniture. Apartment areas are provided as gross internal areas under the RICS measuring practice. Due to the unique design of these homes, measurements and areas may vary within a tolerance of 5%. All garden exterior dimensions and areas are approximate and may vary within a tolerance of 10% subject to detailed design.

3 BEDROOM APARTMENT BLOCK FOUR

Plot Number
D4-1U-02



LOCATOR

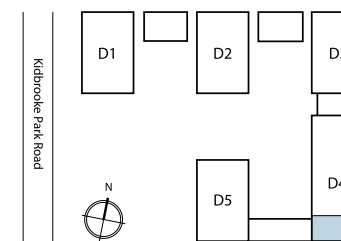

ROOM DIMENSIONS

Living/Dining/Kitchen	6.72m x 5.68m	22'1" x 18'8"
Bedroom 1	3.28m x 3.28m	10'9" x 10'9"
Bedroom 2	4.41m x 2.65m	14'6" x 8'8"
Bedroom 3	4.41m x 2.65m	14'6" x 8'8"
Balcony 1	5.40m x 1.64m	17'9" x 5'4"
Balcony 2	2.71m x 1.64m	8'11" x 5'4"
Total internal area:	101.0 sq m	1087 sq ft

C Structural Column WM Provision for washing machine HIU Heat interface unit ▶◀ Measurement points

TYPE: 12

These layouts are not to scale and provide approximate measurements and are indicative only. Dimensions, which are taken from the indicated points of measurements are for guidance only and are not intended to be used for carpet sizes, appliance space or items of furniture. Apartment areas are provided as gross internal areas under the RICS measuring practice. Due to the unique design of these homes, measurements and areas may vary within a tolerance of 5%. All garden exterior dimensions and areas are approximate and may vary within a tolerance of 10% subject to detailed design.

3 BEDROOM APARTMENT

BLOCK FOUR

Plot Number
D4-2-06



LOCATOR

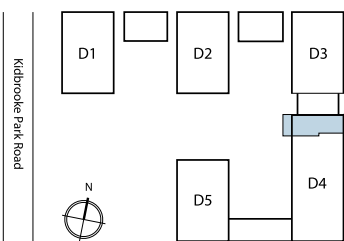

ROOM DIMENSIONS

Living/Dining/Kitchen	9.10m x 3.24m	29'10" x 10'8"
Bedroom 1	3.60m x 3.50m	11'10" x 11'6"
Bedroom 2	4.56m x 2.55m	15'0" x 8'4"
Bedroom 3	3.60m x 2.87m	11'10" x 9'5"
Balcony	5.97m x 1.79m	19'7" x 5'11"
Terrace	5.68m x 2.61m	18'8" x 8'7"

Total internal area: 93.0 sq m 1001 sq ft

C Structural Column WM Provision for washing machine HIU Heat interface unit ◀ ▶ Measurement points

TYPE: 14A

These layouts are not to scale and provide approximate measurements and are indicative only. Dimensions, which are taken from the indicated points of measurements are for guidance only and are not intended to be used for carpet sizes, appliance space or items of furniture. Apartment areas are provided as gross internal areas under the RICS measuring practice. Due to the unique design of these homes, measurements and areas may vary within a tolerance of 5%. All garden exterior dimensions and areas are approximate and may vary within a tolerance of 10% subject to detailed design.

3 BEDROOM APARTMENTS

BLOCK TWO & FIVE

Plot Number
D2-10-04 D5-10-04*



LOCATOR

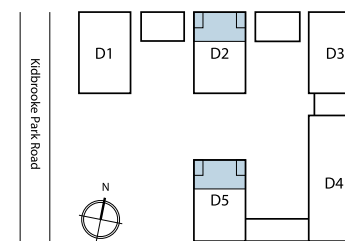

ROOM DIMENSIONS

Living/Dining/Kitchen	7.52m x 5.35m	24'8" x 17'7"
Bedroom 1	3.87m x 3.54m	12'8" x 11'7"
Bedroom 2	3.55m x 3.27m	11'8" x 10'9"
Bedroom 3	4.02m x 2.65m	13'2" x 8'8"
Terrace 1	3.51m x 1.50m	11'6" x 4'11"
Terrace 2	3.51m x 1.50m	11'6" x 4'11"

Total internal area: 118.0 sq m 1270 sq ft

* Plot is handed

C Structural Column WM Provision for washing machine HIU Heat interface unit ◀ ▶ Measurement points

TYPE: 24

These layouts are not to scale and provide approximate measurements and are indicative only. Dimensions, which are taken from the indicated points of measurements are for guidance only and are not intended to be used for carpet sizes, appliance space or items of furniture. Apartment areas are provided as gross internal areas under the RICS measuring practice. Due to the unique design of these homes, measurements and areas may vary within a tolerance of 5%. Kitchen layouts are indicative only and are subject to change. All garden exterior dimensions and areas are approximate and may vary within a tolerance of 10% subject to detailed design.



PENTHOUSE

A SELECTION OF PENTHOUSES
WITH STUNNING VIEWS

2 BEDROOM PENTHOUSE APARTMENTS BLOCKS ONE & TWO

Plot Numbers
D1-11-04 D2-13-04

LOWER FLOOR



UPPER FLOOR



LOCATOR

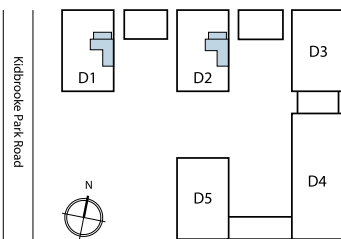

ROOM DIMENSIONS

Living/Dining/Kitchen	9.71m x 3.54m	31'10" x 11'8"
Balcony 1	4.73m x 1.50m	15'7" x 4'11"
Total internal area:	98.0 sq m	1055 sq ft

ROOM DIMENSIONS

Bedroom 1	3.89m x 3.54m	12'9" x 11'8"
Bedroom 2	3.60m x 3.20m	11'10" x 10'6"
Balcony 2	4.73m x 1.50m	15'7" x 4'11"

C Structural Column WM Provision for washing machine HIU Heat interface unit ◀ ▶ Measurement points

TYPE: PH3A

These layouts are not to scale and provide approximate measurements and are indicative only. Dimensions, which are taken from the indicated points of measurements are for guidance only and are not intended to be used for carpet sizes, appliance space or items of furniture. Apartment areas are provided as gross internal areas under the RICS measuring practice. Due to the unique design of these homes, measurements and areas may vary within a tolerance of 5%. Kitchen layouts are indicative only and are subject to change. All garden exterior dimensions and areas are approximate and may vary within a tolerance of 10% subject to detailed design.

2 BEDROOM PENTHOUSE APARTMENTS BLOCK FIVE

Plot Numbers
D5-10-03 D5-10-05*

LOWER FLOOR



LOCATOR

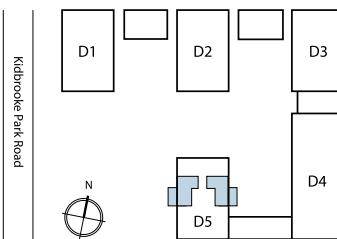

ROOM DIMENSIONS

Living/Dining/Kitchen	9.60m x 3.66m	31'6" x 12'0"
Balcony	3.38m x 2.01m	11'1" x 6'7"
Total internal area:	100.0 sq m	1076 sq ft

UPPER FLOOR



ROOM DIMENSIONS

Bedroom 1	3.90m x 3.66m	12'10" x 12'0"
Bedroom 2	3.50m x 3.32m	11'6" x 10'11"

* Plot is handed

C Structural Column WM Provision for washing machine HIU Heat interface unit ◀ ▶ Measurement points

TYPE: PH3B

These layouts are not to scale and provide approximate measurements and are indicative only. Dimensions, which are taken from the indicated points of measurements are for guidance only and are not intended to be used for carpet sizes, appliance space or items of furniture. Apartment areas are provided as gross internal areas under the RICS measuring practice. Due to the unique design of these homes, measurements and areas may vary within a tolerance of 5%. Kitchen layouts are indicative only and are subject to change. All garden exterior dimensions and areas are approximate and may vary within a tolerance of 10% subject to detailed design.

2 BEDROOM PENTHOUSE APARTMENTS BLOCK THREE

Plot Numbers
D3-16-01* D3-16-04

LOWER FLOOR



UPPER FLOOR



LOCATOR

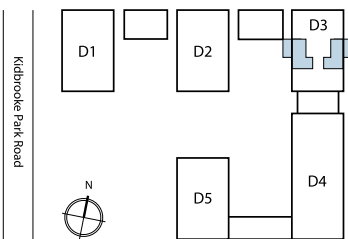

ROOM DIMENSIONS

Living/Dining/Kitchen	9.60m x 3.66m	31'6" x 12'0"
Balcony	3.38m x 2.01m	11'1" x 6'7"
Total internal area:	103.0 sq m	1109 sq ft

ROOM DIMENSIONS

Bedroom 1	3.89m x 3.66m	12'9" x 12'0"
Bedroom 2	3.56m x 3.50m	11'8" x 11'5"

* Plot is handed

C Structural Column WM Provision for washing machine HIU Heat interface unit ◀ ▶ Measurement points

TYPE: PH7

These layouts are not to scale and provide approximate measurements and are indicative only. Dimensions, which are taken from the indicated points of measurements are for guidance only and are not intended to be used for carpet sizes, appliance space or items of furniture. Apartment areas are provided as gross internal areas under the RICS measuring practice. Due to the unique design of these homes, measurements and areas may vary within a tolerance of 5%. Kitchen layouts are indicative only and are subject to change. All garden exterior dimensions and areas are approximate and may vary within a tolerance of 10% subject to detailed design.

2 BEDROOM PENTHOUSE APARTMENTS BLOCKS ONE & TWO

Plot Numbers
D1-12-01 D2-14-01



LOCATOR

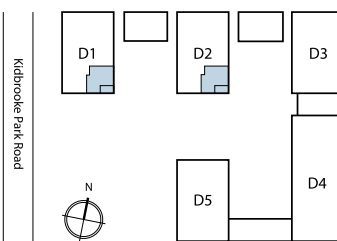

ROOM DIMENSIONS

Living/Dining/Kitchen	5.61m x 4.06m	18'5" x 13'4"
Bedroom 1	3.61m x 3.20m	11'10" x 10'6"
Bedroom 2	4.01m x 2.50m	13'2" x 8'2"
Balcony	3.51m x 1.50m	11'6" x 4'11"
Total internal area:	64.0 sq m	689 sq ft

* Plot is handed C Structural Column WM Provision for washing machine HIU Heat interface unit ◀ ▶ Measurement points

TYPE: PH5B

These layouts are not to scale and provide approximate measurements and are indicative only. Dimensions, which are taken from the indicated points of measurements are for guidance only and are not intended to be used for carpet sizes, appliance space or items of furniture. Apartment areas are provided as gross internal areas under the RICS measuring practice. Due to the unique design of these homes, measurements and areas may vary within a tolerance of 5%. All garden exterior dimensions and areas are approximate and may vary within a tolerance of 10% subject to detailed design.

CENTRUM COURT

3 BEDROOM PENTHOUSE APARTMENT BLOCK ONE

Plot Number
D1-9-04



LOCATOR

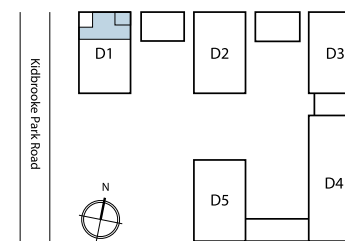

ROOM DIMENSIONS

Living/Dining/Kitchen	6.39m x 4.01m	20'0" x 13'2"
Bedroom 1	3.96m x 3.35m	13'0" x 11'0"
Bedroom 2	4.02m x 3.11m	13'2" x 10'3"
Bedroom 3	4.02m x 2.67m	13'2" x 8'9"
Terrace	3.76m x 3.76m	12'4" x 12'4"
Total internal area:	101.0 sq m	1087 sq ft

C Structural Column WM Provision for washing machine HIU Heat interface unit ▶ Measurement points

TYPE: PH2

These layouts are not to scale and provide approximate measurements and are indicative only. Dimensions, which are taken from the indicated points of measurements are for guidance only and are not intended to be used for carpet sizes, appliance space or items of furniture. Apartment areas are provided as gross internal areas under the RICS measuring practice. Due to the unique design of these homes, measurements and areas may vary within a tolerance of 5%. Kitchen layouts are indicative only and are subject to change. All garden exterior dimensions and areas are approximate and may vary within a tolerance of 10% subject to detailed design.

111

3 BEDROOM PENTHOUSE APARTMENTS BLOCKS ONE & TWO

Plot Numbers
D1-11-03 D2-13-03

LOWER FLOOR



UPPER FLOOR



LOCATOR

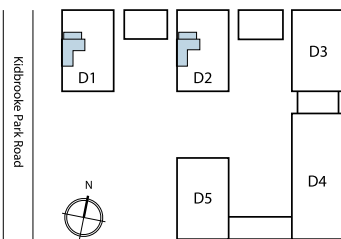

ROOM DIMENSIONS

Living/Dining/Kitchen	9.69m x 3.54m	31'10" x 11'8"
Balcony 1	4.73m x 1.38m	15'7" x 4'7"
Total internal area:	106.0 sq m	1141 sq ft

ROOM DIMENSIONS

Bedroom 1	3.90m x 3.54m	12'10" x 11'8"
Bedroom 2	3.18m x 2.30m	10'5" x 7'7"
Bedroom 3	4.16m x 2.81m	13'8" x 9'3"
Balcony 2	4.73m x 1.38m	15'7" x 4'7"

C Structural Column WM Provision for washing machine HIU Heat interface unit ◀ ▶ Measurement points

TYPE: PH3C

These layouts are not to scale and provide approximate measurements and are indicative only. Dimensions, which are taken from the indicated points of measurements are for guidance only and are not intended to be used for carpet sizes, appliance space or items of furniture. Apartment areas are provided as gross internal areas under the RICS measuring practice. Due to the unique design of these homes, measurements and areas may vary within a tolerance of 5%. Kitchen layouts are indicative only and are subject to change. All garden exterior dimensions and areas are approximate and may vary within a tolerance of 10% subject to detailed design.

3 BEDROOM PENTHOUSE APARTMENTS BLOCKS ONE & TWO

Plot Numbers
D1-11-02 D2-13-02

LOWER FLOOR



UPPER FLOOR



LOCATOR

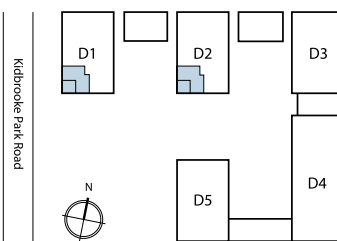

ROOM DIMENSIONS

Living Area	5.12m x 5.11m	16'10" x 16'9"
Dining/Kitchen	4.56m x 3.56m	15'0" x 11'8"
Terrace	3.76m x 3.76m	12'4" x 12'4"
Total internal area:	110.0 sq m	1184 sq ft

ROOM DIMENSIONS

Bedroom 1	4.51m x 3.01m	14'10" x 9'11"
Bedroom 2	3.31m x 2.85m	10'10" x 9'4"
Bedroom 3	4.28m x 2.01m	14'1" x 6'7"

C Structural Column WM Provision for washing machine HIU Heat interface unit ◀ ▶ Measurement points

TYPE: PH4A

These layouts are not to scale and provide approximate measurements and are indicative only. Dimensions, which are taken from the indicated points of measurements are for guidance only and are not intended to be used for carpet sizes, appliance space or items of furniture. Apartment areas are provided as gross internal areas under the RICS measuring practice. Due to the unique design of these homes, measurements and areas may vary within a tolerance of 5%. Kitchen layouts are indicative only and are subject to change. All garden exterior dimensions and areas are approximate and may vary within a tolerance of 10% subject to detailed design.

3 BEDROOM PENTHOUSE APARTMENTS BLOCK THREE

Plot Numbers
D3-16-05 D3-16-06*

LOWER FLOOR



UPPER FLOOR



LOCATOR

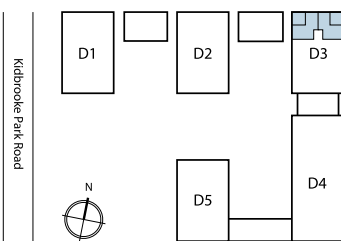

ROOM DIMENSIONS

Living Area	5.12m x 5.11m	16'10" x 16'9"
Dining/Kitchen	4.56m x 3.56m	15'0" x 11'8"
Terrace	3.76m x 3.76m	12'4" x 12'4"
Total internal area:	112.0 sq m	1206 sq ft

ROOM DIMENSIONS

Bedroom 1	4.51m x 3.03m	14'10" x 10'10"
Bedroom 2	3.31m x 2.85m	10'10" x 9'4"
Bedroom 3	4.28m x 2.01m	14'1" x 6'7"

* Plot is handed

C Structural Column WM Provision for washing machine HIU Heat interface unit ◀ ▶ Measurement points

TYPE: PH4B

These layouts are not to scale and provide approximate measurements and are indicative only. Dimensions, which are taken from the indicated points of measurements are for guidance only and are not intended to be used for carpet sizes, appliance space or items of furniture. Apartment areas are provided as gross internal areas under the RICS measuring practice. Due to the unique design of these homes, measurements and areas may vary within a tolerance of 5%. Kitchen layouts are indicative only and are subject to change. All garden exterior dimensions and areas are approximate and may vary within a tolerance of 10% subject to detailed design.

3 BEDROOM PENTHOUSE APARTMENTS BLOCK FIVE

Plot Numbers
D5-10-01* D5-10-02

LOWER FLOOR



UPPER FLOOR



LOCATOR

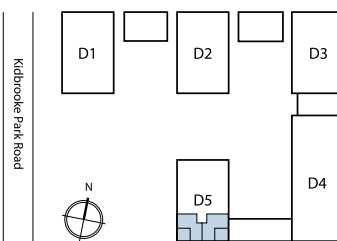

ROOM DIMENSIONS

Living Area	5.12m x 5.10m	16'10" x 16'9"
Dining/Kitchen	4.56m x 3.56m	15'0" x 11'8"
Terrace	3.76m x 3.76m	12'4" x 12'4"
Total internal area:	112.0 sq m	1206 sq ft

ROOM DIMENSIONS

Bedroom 1	4.51m x 3.01m	14'10" x 9'11"
Bedroom 2	3.30m x 2.85m	10'10" x 9'4"
Bedroom 3	4.28m x 2.03m	14'0" x 6'8"

* Plot is handed

C Structural Column WM Provision for washing machine HIU Heat interface unit ◀ ▶ Measurement points

TYPE: PH4C

These layouts are not to scale and provide approximate measurements and are indicative only. Dimensions, which are taken from the indicated points of measurements are for guidance only and are not intended to be used for carpet sizes, appliance space or items of furniture. Apartment areas are provided as gross internal areas under the RICS measuring practice. Due to the unique design of these homes, measurements and areas may vary within a tolerance of 5%. Kitchen layouts are indicative only and are subject to change. All garden exterior dimensions and areas are approximate and may vary within a tolerance of 10% subject to detailed design.

3 BEDROOM PENTHOUSE APARTMENTS BLOCK THREE

Plot Numbers
D3-16-02* D3-16-03

LOWER FLOOR



UPPER FLOOR



LOCATOR

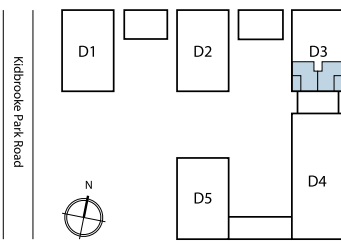

ROOM DIMENSIONS

Living/Dining	6.91m x 4.36m	22'8" x 14'3"
Kitchen	2.76m x 3.98m	9'1" x 13'1"
Terrace	3.50m x 1.51m	11'6" x 4'11"
Total internal area:	112.0 sq m	1206 sq ft

ROOM DIMENSIONS

Bedroom 1	4.03m x 2.55m	13'3" x 8'5"
Bedroom 2	3.51m x 3.31m	11'7" x 10'10"
Bedroom 3	4.03m x 2.15m	13'3" x 7'11"
Balcony	3.50m x 1.51m	11'6" x 4'11"

* Plot is handed

C Structural Column WM Provision for washing machine HIU Heat interface unit ◀ ▶ Measurement points

TYPE: PH8

These layouts are not to scale and provide approximate measurements and are indicative only. Dimensions, which are taken from the indicated points of measurements are for guidance only and are not intended to be used for carpet sizes, appliance space or items of furniture. Apartment areas are provided as gross internal areas under the RICS measuring practice. Due to the unique design of these homes, measurements and areas may vary within a tolerance of 5%. Kitchen layouts are indicative only and are subject to change. All garden exterior dimensions and areas are approximate and may vary within a tolerance of 10% subject to detailed design.

3 BEDROOM PENTHOUSE APARTMENTS BLOCKS TWO & FIVE

Plot Numbers
D2-11-04 D5-11-04*



LOCATOR

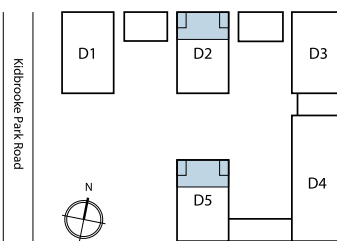

ROOM DIMENSIONS

Living/Dining/Kitchen	7.52m x 5.35m	24'8" x 17'7"
Bedroom 1	3.87m x 3.54m	12'8" x 11'7"
Bedroom 2	3.55m x 3.27m	11'8" x 10'9"
Bedroom 3	4.02m x 2.65m	13'2" x 8'8"
Balcony 1	3.51m x 1.50m	11'6" x 4'11"
Balcony 2	3.51m x 1.50m	11'6" x 4'11"
Total internal area:	118.0 sq m	1270 sq ft

* Plot is handed C Structural Column WM Provision for washing machine HIU Heat interface unit ▶ Measurement points

* Plot is handed

These layouts are not to scale and provide approximate measurements and are indicative only. Dimensions, which are taken from the indicated points of measurements are for guidance only and are not intended to be used for carpet sizes, appliance space or items of furniture. Apartment areas are provided as gross internal areas under the RICS measuring practice. Due to the unique design of these homes, measurements and areas may vary within a tolerance of 5%. Kitchen layouts are indicative only and are subject to change. All garden exterior dimensions and areas are approximate and may vary within a tolerance of 10% subject to detailed design.

TYPE: PH6



Photography of The Kidbrooke Village Showhome, indicative only



CGI of a Centrum Court apartment, indicative only



TURYAP[®]
UK

TOWNHOUSES

A SELECTION OF
2 AND 3 BEDROOM TOWNHOUSES

2 BEDROOM TOWNHOUSE

House Number
D-G-05

GROUND FLOOR

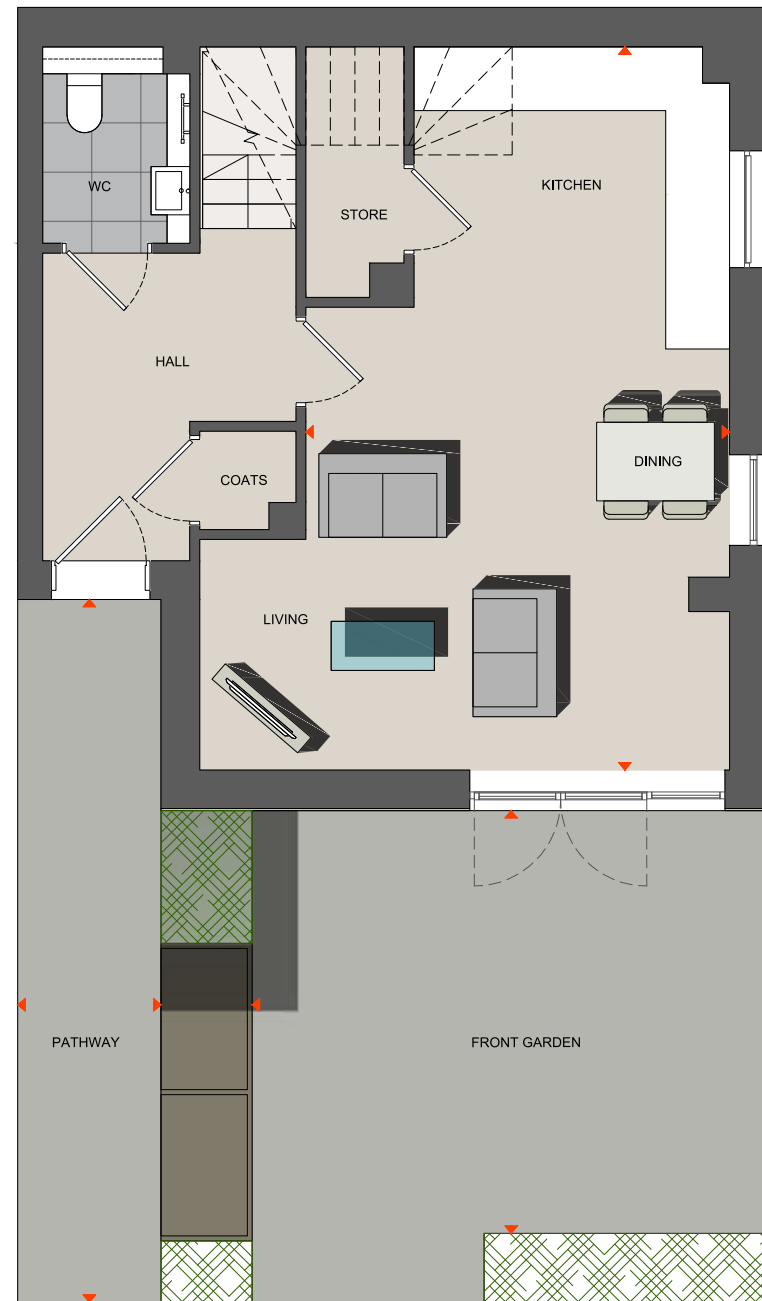

LOCATOR

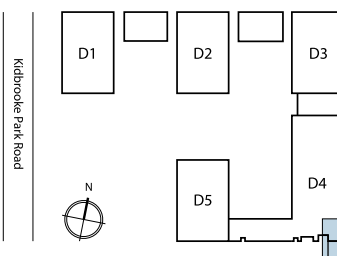

ROOM DIMENSIONS

Living/Dining/Kitchen	7.36m x 4.31m	24'2" x 14'2"
Front Garden	5.19m x 4.41m	17'0" x 14'6"
Pathway	7.15m x 1.35m	20'5" x 4'5"
Total internal area:	90.0 sq m	969 sq ft

FIRST FLOOR

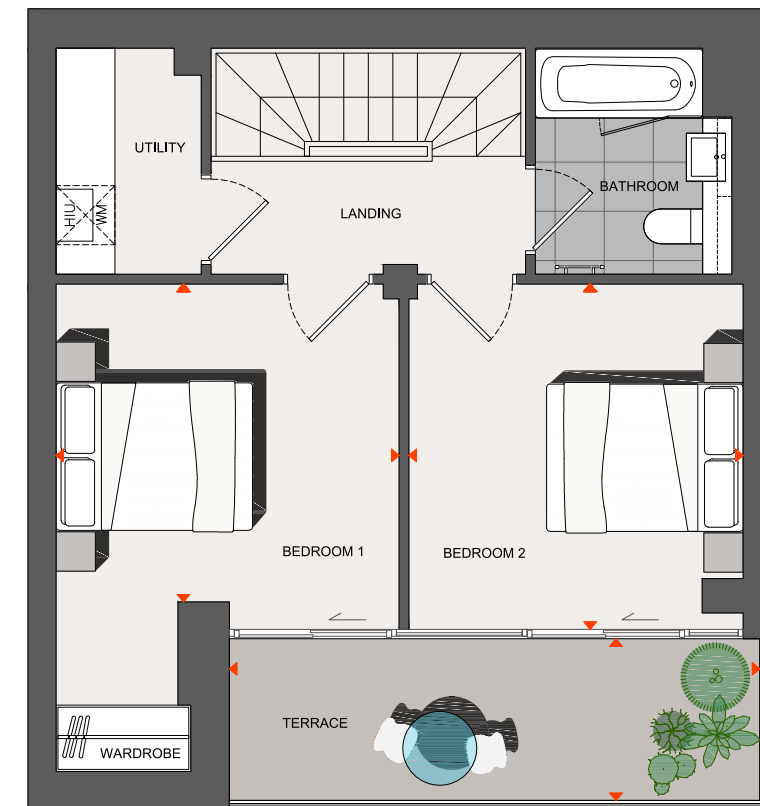

ROOM DIMENSIONS

Bedroom 1	3.51m x 3.28m	11'6" x 10'9"
Bedroom 2	3.33m x 3.26m	10'11" x 10'9"
Terrace	5.42m x 1.64m	17'10" x 5'5"

C Structural Column WM Provision for washing machine HIU Heat interface unit ◀ ▶ Measurement points

TYPE: TH4

These layouts are not to scale and provide approximate measurements and are indicative only. Dimensions, which are taken from the indicated points of measurements are for guidance only and are not intended to be used for carpet sizes, appliance space or items of furniture. Apartment areas are provided as gross internal areas under the RICS measuring practice. Due to the unique design of these homes, measurements and areas may vary within a tolerance of 5%. Kitchen layouts are indicative only and are subject to change. All garden exterior dimensions and areas are approximate and may vary within a tolerance of 10% subject to detailed design.

3 BEDROOM TOWNHOUSES

House Numbers
D-G-01 D-G-02

GROUND FLOOR



LOCATOR

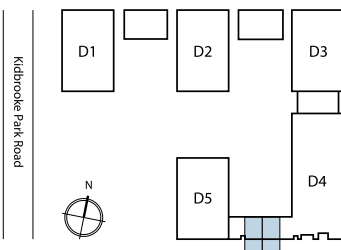

ROOM DIMENSIONS

Living/Dining/Kitchen	6.79m x 6.46m	22'4" x 21'2"
Front Garden	6.29m x 4.74m	20'8" x 15'7"
Total internal area:	127.0 sq m	1367 sq ft

FIRST FLOOR

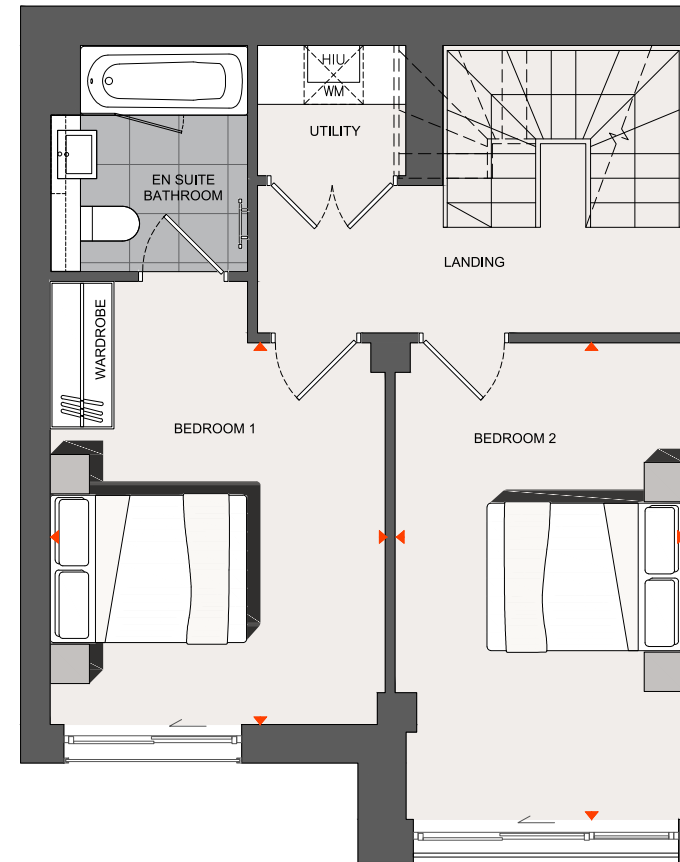

ROOM DIMENSIONS

Bedroom 1	3.88m x 3.41m	12'9" x 11'2"
Bedroom 2	4.90m x 2.95m	16'1" x 9'8"

SECOND FLOOR

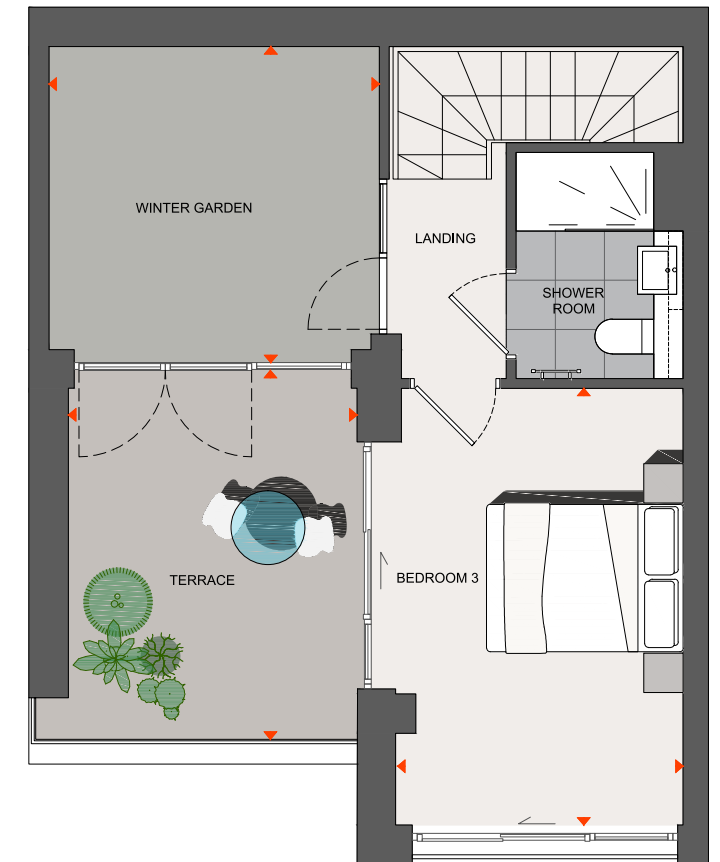

ROOM DIMENSIONS

Bedroom 3	4.45m x 2.98m	14'7" x 9'10"
Winter Garden	3.36m x 3.13m	11'0" x 10'3"
Terrace	3.77m x 2.93m	12'5" x 9'8"

C Structural Column WM Provision for washing machine HIU Heat interface unit ◀ ▶ Measurement points

TYPE: TH1

These layouts are not to scale and provide approximate measurements and are indicative only. Dimensions, which are taken from the indicated points of measurements are for guidance only and are not intended to be used for carpet sizes, appliance space or items of furniture. Apartment areas are provided as gross internal areas under the RICS measuring practice. Due to the unique design of these homes, measurements and areas may vary within a tolerance of 5%. Kitchen layouts are indicative only and are subject to change. All garden exterior dimensions and areas are approximate and may vary within a tolerance of 10% subject to detailed design.

3 BEDROOM TOWNHOUSE

House Number
D-G-03

GROUND FLOOR

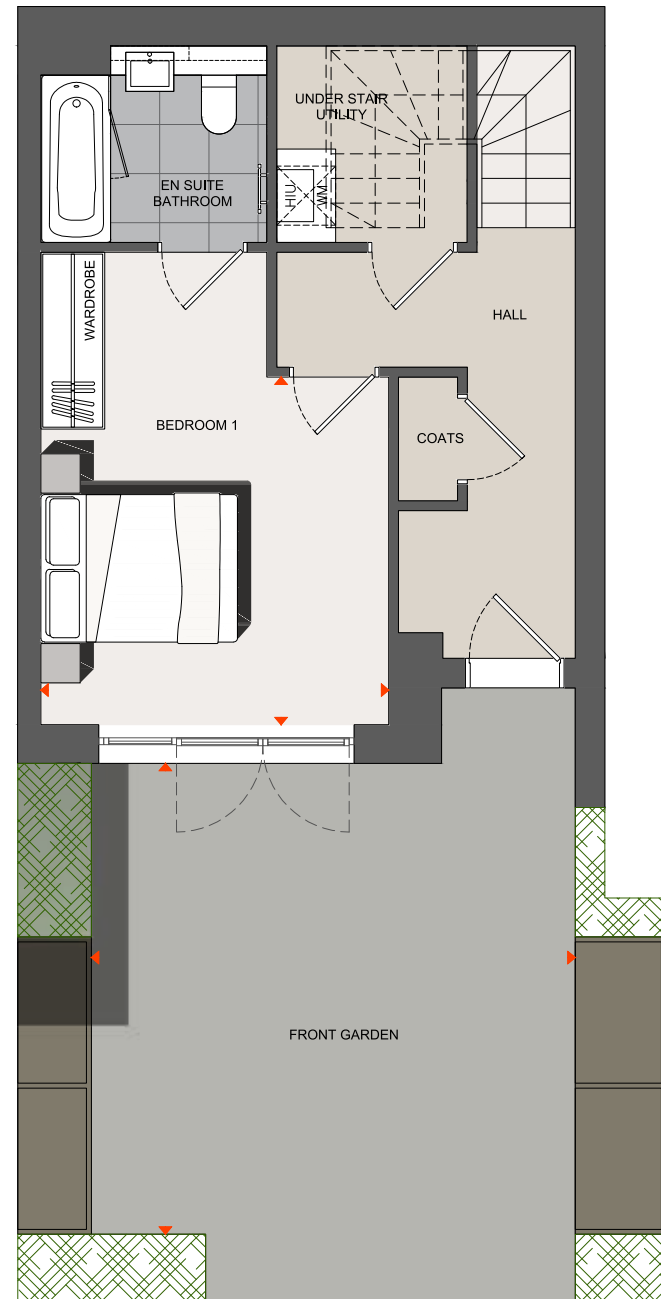

FIRST FLOOR

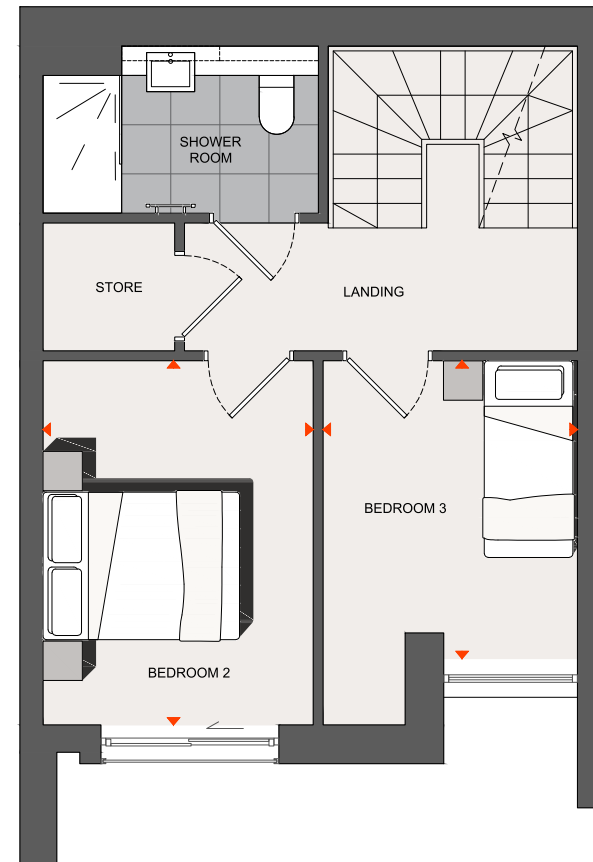

SECOND FLOOR

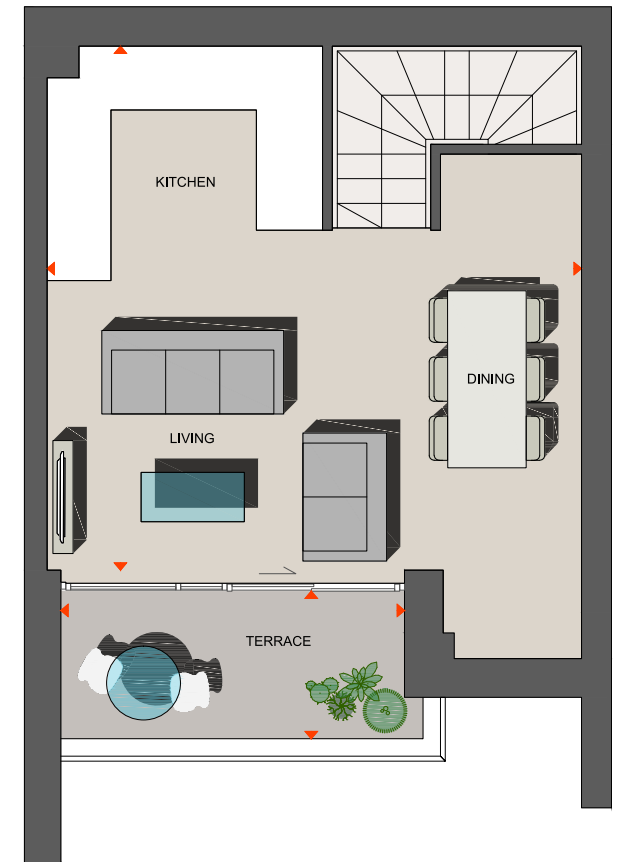

LOCATOR

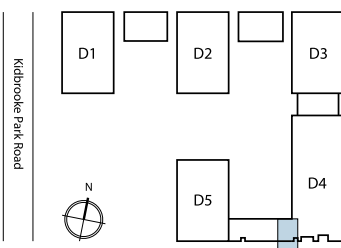

ROOM DIMENSIONS

Bedroom 1	3.54m x 3.42m	11'7" x 11'3"
Front Garden	4.92m x 4.76m	16'2" x 15'8"
Total internal area:	102.0 sq m	1098 sq ft

ROOM DIMENSIONS

Bedroom 2	3.86m x 2.90m	12'8" x 9'6"
Bedroom 3	2.92m x 2.44m	9'7" x 8'0"

ROOM DIMENSIONS

Living/Dining/Kitchen	5.44m x 5.33m	17'10" x 17'6"
Terrace	3.38m x 1.50m	11'1" x 4'11"

C Structural Column WM Provision for washing machine HIU Heat interface unit ◀ ▶ Measurement points

TYPE: TH2

These layouts are not to scale and provide approximate measurements and are indicative only. Dimensions, which are taken from the indicated points of measurements are for guidance only and are not intended to be used for carpet sizes, appliance space or items of furniture. Apartment areas are provided as gross internal areas under the RICS measuring practice. Due to the unique design of these homes, measurements and areas may vary within a tolerance of 5%. Kitchen layouts are indicative only and are subject to change. All garden exterior dimensions and areas are approximate and may vary within a tolerance of 10% subject to detailed design.

3 BEDROOM TOWNHOUSE

House Number
D-G-04

GROUND FLOOR

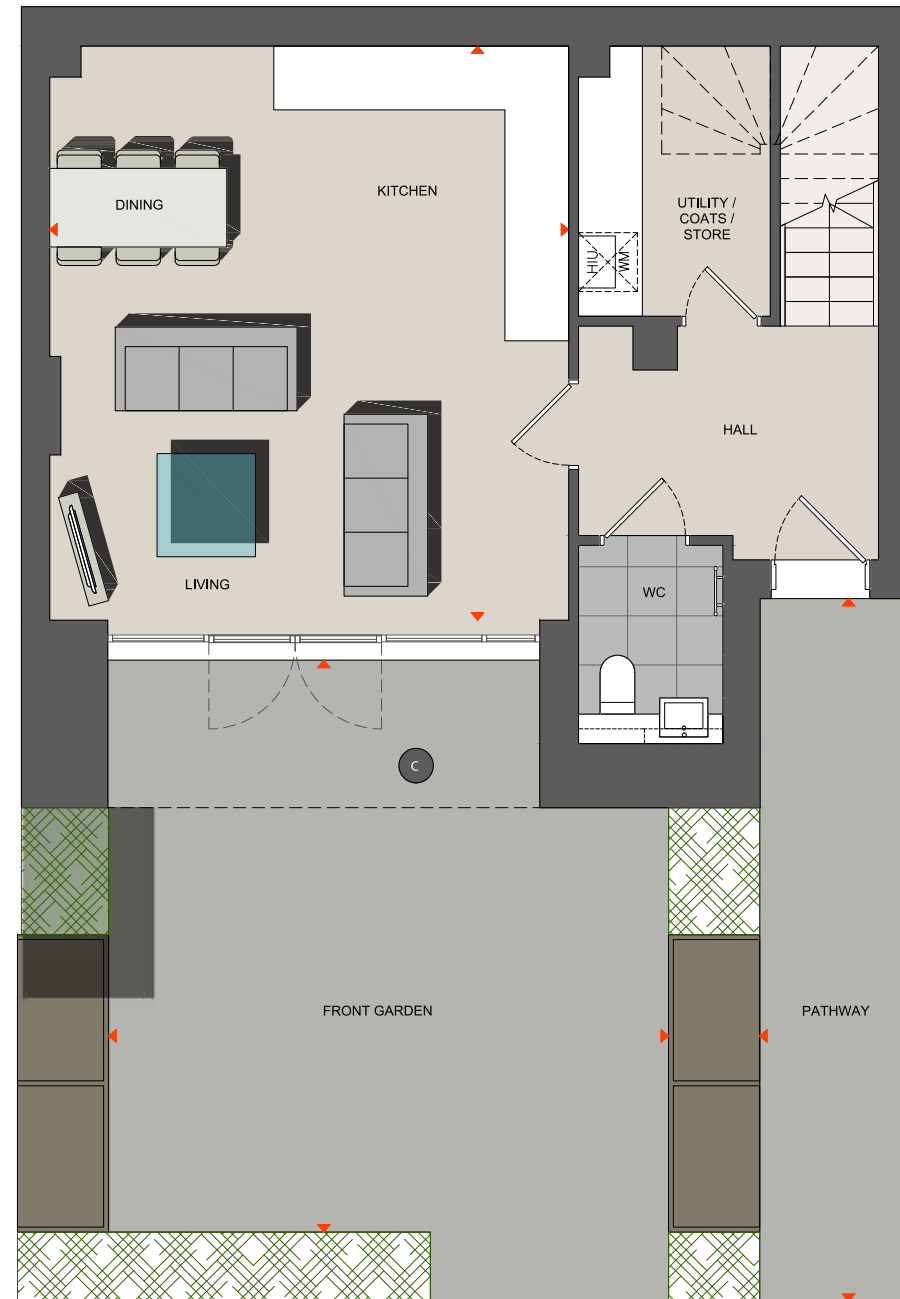

LOCATOR

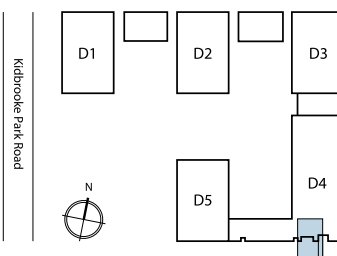

ROOM DIMENSIONS

Living/Dining/Kitchen	5.68m x 5.28m	18'8" x 17'4"
Front Garden	6.00m x 5.61m	19'8" x 18'5"
Pathway	7.15m x 1.35m	20'5" x 4'5"
Total internal area:	106.0 sq m	1141 sq ft

C Structural Column WM Provision for washing machine HIU Heat interface unit ◀ ▶ Measurement points

TYPE: TH3

FIRST FLOOR

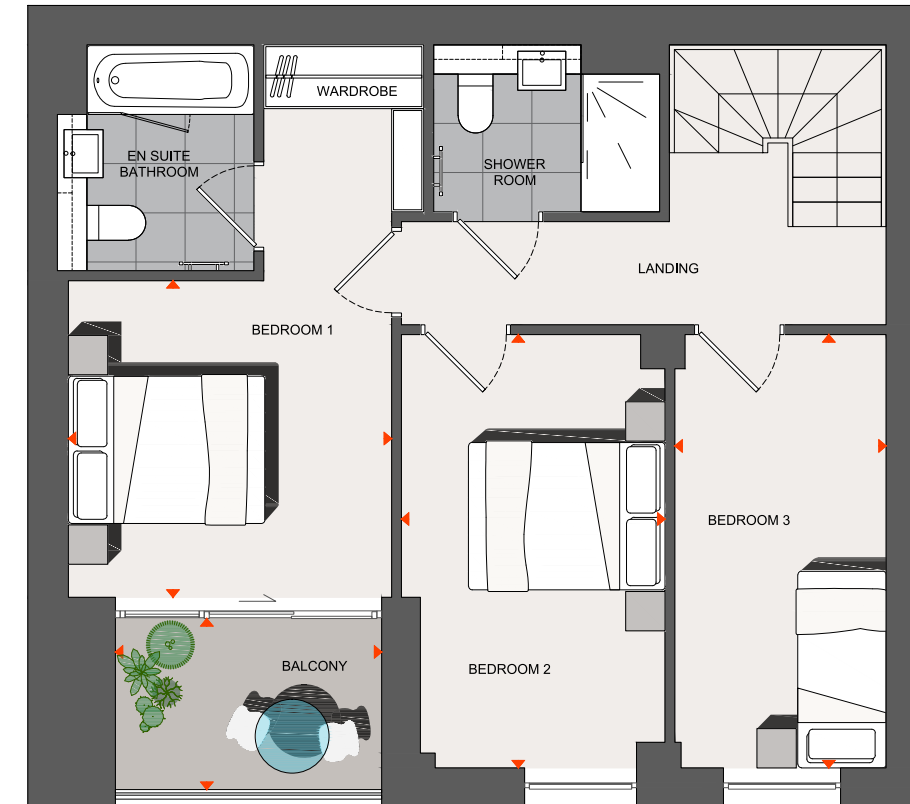

ROOM DIMENSIONS

Bedroom 1	3.29m x 3.29m	10'9" x 10'9"
Bedroom 2	4.41m x 2.68m	14'6" x 8'10"
Bedroom 3	4.41m x 2.15m	14'6" x 7'1"
Balcony	2.71m x 1.70m	8'11" x 5'8"

These layouts are not to scale and provide approximate measurements and are indicative only. Dimensions, which are taken from the indicated points of measurements are for guidance only and are not intended to be used for carpet sizes, appliance space or items of furniture. Apartment areas are provided as gross internal areas under the RICS measuring practice. Due to the unique design of these homes, measurements and areas may vary within a tolerance of 5%. Kitchen layouts are indicative only and are subject to change. All garden exterior dimensions and areas are approximate and may vary within a tolerance of 10% subject to detailed design.